

Madison, Wisconsin

# CITY OF MADISON

## CITY ENGINEERING DIVISION

### DEPARTMENT OF PUBLIC WORKS

# PLAN OF PROPOSED IMPROVEMENT

PUBLIC IMPROVEMENT PROJECT APPROVED

MAY 21, 2019

BY THE COMMON COUNCIL OF MADISON, WISCONSIN

PUBLIC IMPROVEMENT DESIGN APPROVED BY:

*[Signature]* 6/6/19  
City Engineer Date

INDEX OF SHEETS

SHEET NO.	TITLE
1	SPEED HUMPS
SH1-5	GREEN BIKE MARKINGS
GB1-4	ATWOOD AVE.
A1	DUTCH MILL RD.
D1	S. GAMMON RD.
GA1-2	E. GORHAM ST.
GO1	N. HIGH POINT RD.
HP1	MID TOWN RD.
MT1-2	ODANA RD.
OD1-4	W. OLIN AVE.
OL1	PACKERS AVE.
PS1	SCHROEDER RD.
SC1	E. WASHINGTON AVE.
WA1	WISCONSIN AVE.
WG1	WILLIAMSON ST.
WI1	

## LOCAL ROAD TRAFFIC CALMING & ARTERIAL PEDESTRIAN ENHANCEMENTS - 2019

CITY PROJECT NO. 11877  
CITY CONTRACT NO. 8315

### CITY-WIDE PROJECT LOCATIONS

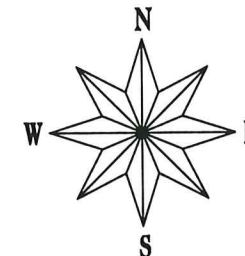
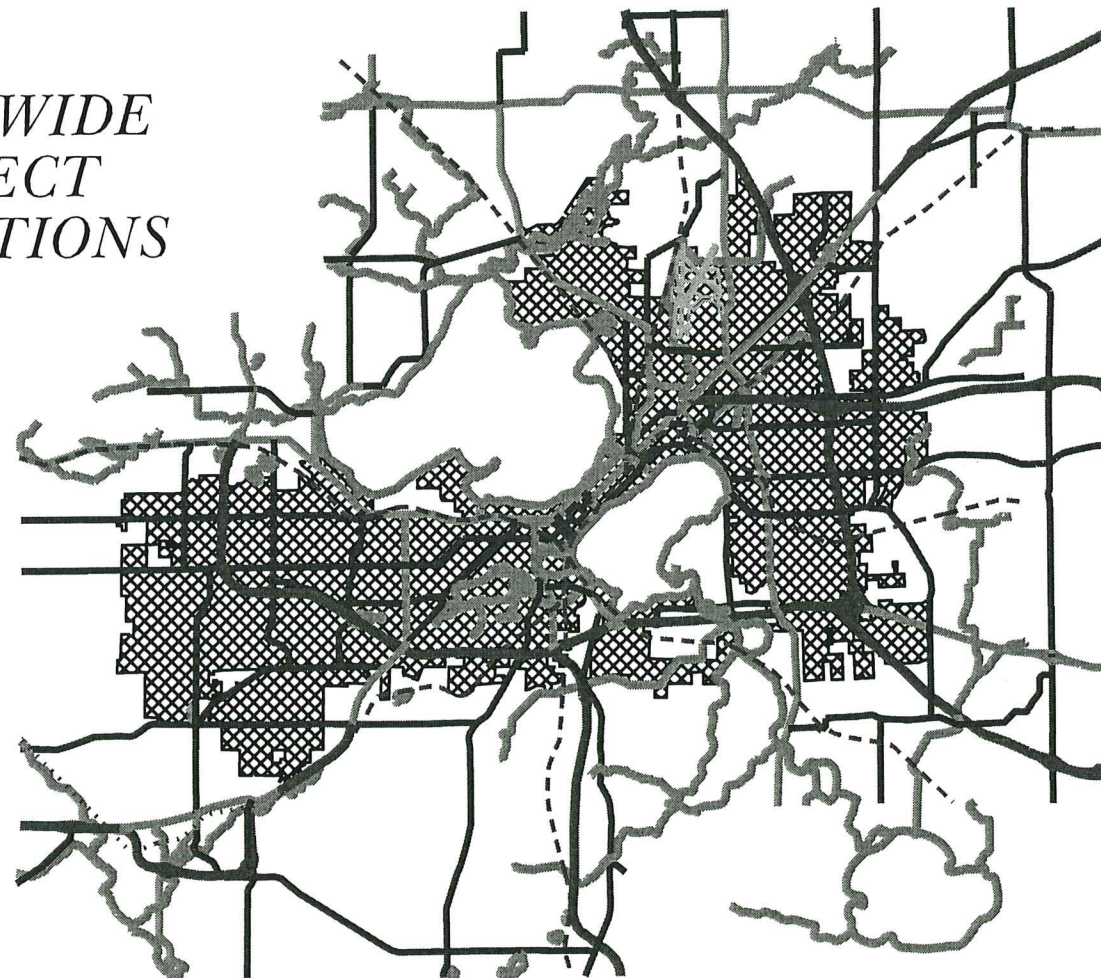

GEOMETRICS DESIGNED BY:



STREET GRADES DESIGNED BY:



CONVENTIONAL SIGNS

FIELD VERIFY ALL UTILITY LOCATIONS

GAS	— G —
STORM SEWER	— ST —
SANITARY SEWER	— SAN —
WATER	— W —
OVERHEAD ELECTRIC	— OH —
POWER POLE	⊕
ADA COMPLIANT RAMP W/ DETECTABLE WARNING FIELD	
COMBUSTIBLE FLUIDS	

NOTES:

ALL GUTTERS SHALL DRAIN WITH A MINIMUM GRADE OF 0.50% TOWARD STORM SEWER INLETS.

SIDEWALK RAMPS AND CURB THRU SIDEWALK RAMPS SHALL HAVE A MAXIMUM SLOPE OF 1" PER 12". SIDEWALK AND CURB RAMPS SHALL BE CONSTRUCTED WITH A SIDE SLOPE OF 1.50%. SIDEWALK SHALL HAVE A MINIMUM LONGITUDINAL SLOPE OF 0.50% AND A MAXIMUM LONGITUDINAL SLOPE OF 5.00% EXCEPT WHERE STREET GRADES EXCEED 5.00%.

EARTH WORK SUMMARY:  
EXCAVATION CUT (MEASURED PLAN QUANTITY).....477 C.Y.  
ESTIMATED UNDISTRIBUTED UNDERCUT.....0 C.Y.  
TOTAL UNCLASSIFIED EXCAVATION CUT.....477 C.Y.

PLOT SCALE:

PLOT NAME:

REV. DATE:

ORIGINATOR: CITY OF MADISON, STREETS DIVISION

SPEED HUMP PLAN

LAKE POINT DR CITY OF MADISON



ORIGINATOR: CITY OF MADISON, TRAFFIC ENG. DIV.  
REV. DATE:  
PLOT NAME:  
PLOT SCALE:



NOTES:  
1. INSTALL SPEED HUMPS PER S.D.D. 4.10 WITH FLOW-THRU GUTTER.  
2. SAWCUT ASPHALT PAVEMENT AT EDGE OF PROPOSED SPEED HUMP.

SPEED HUMP PLAN

SPAIGHT ST CITY OF MADISON

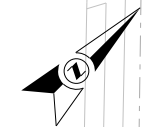

**NOTES:**  
1. INSTALL SPEED HUMPS PER S.D.D. 4.10 WITH FLOW-THRU GUTTER.  
2. SAWCUT ASPHALT PAVEMENT AT EDGE OF PROPOSED SPEED HUMP.

S BALDWIN ST

S DICKINSON ST

SPEED HUMP [Symbol] SPAIGHT ST [Symbol] SPEED HUMP

[Symbol] SPEED HUMP

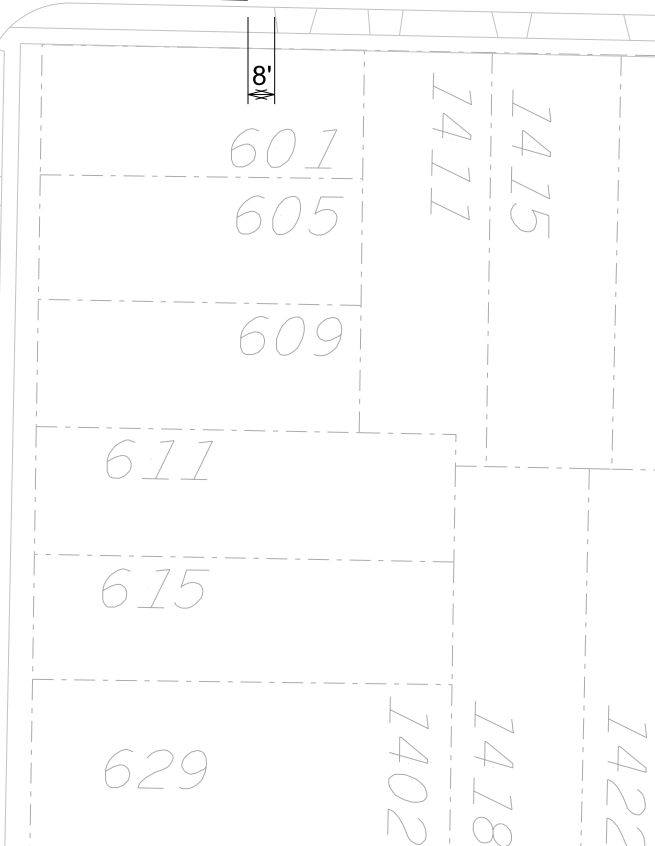
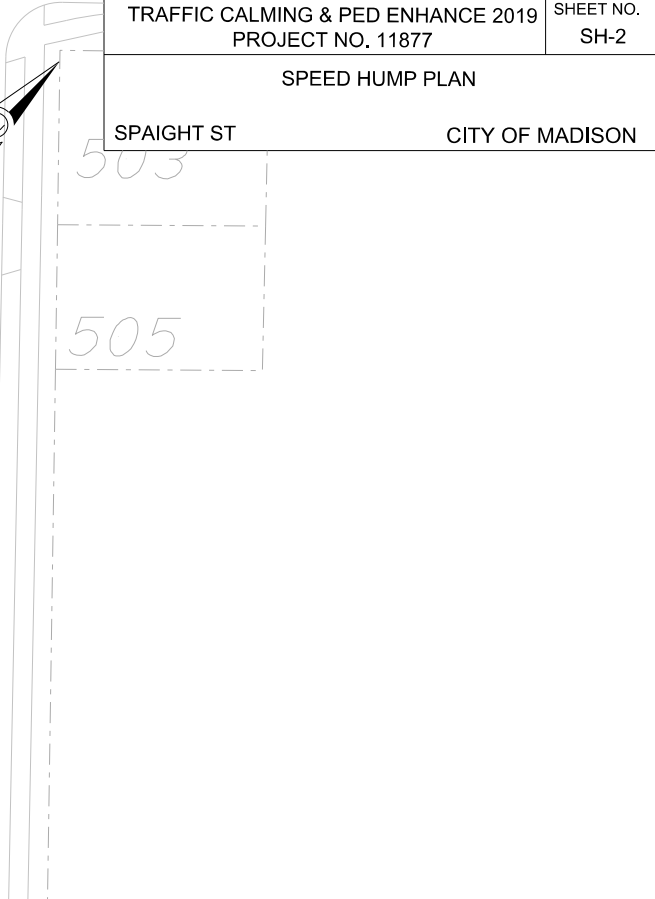
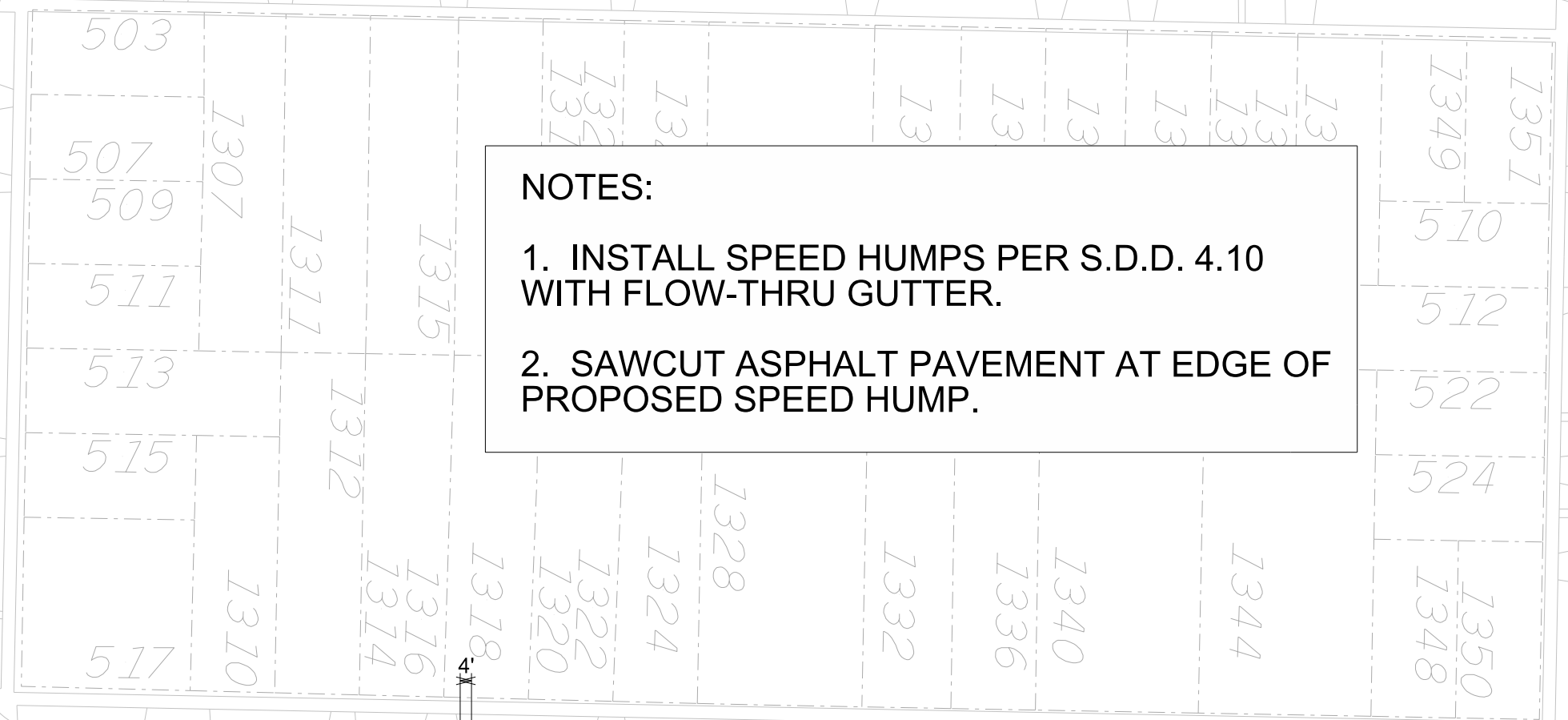

PLOT SCALE:

PLOT NAME:

REV. DATE:

ORIGINATOR: CITY OF MADISON, TRAFFIC ENG. DIV.

SPEED HUMP PLAN

BROWNING RD

CITY OF MADISON



NOTES:

1. INSTALL SPEED HUMPS PER S.D.D. 4.10 WITH FLOW-THRU GUTTER.
2. SAWCUT ASPHALT PAVEMENT AT EDGE OF PROPOSED SPEED HUMP.

SPEED HUMP

SPEED HUMP

BROWNING RD

SPEED HUMP

N SHERMAN AVE

DRYDEN DR

1701

1714

1802

1800

1810

1709

1713

1717

3405

3414

3410

3400

3406

3402

3409

3405

3401

3401

1706

1710

1714

1718

1700

1730

1800

3400

335A  
202

1701

1705

1709

1713

1717

1721

1725

1729

1733

1805

1809

1813

1817

1821

1825

1829

1702

1706

1710

1714

1718

1722

1726

1730

1734

1738

1742

1746

3101

PLOT SCALE:

PLOT NAME:

REV. DATE:

ORIGINATOR: CITY OF MADISON, TRAFFIC ENG. DIV.



SPEED HUMP

SPEED HUMP

NOTES:

- 1. INSTALL SPEED HUMPS PER S.D.D. 4.10 WITH FLOW-THRU GUTTER.
- 2. SAWCUT ASPHALT PAVEMENT AT EDGE OF PROPOSED SPEED HUMP.

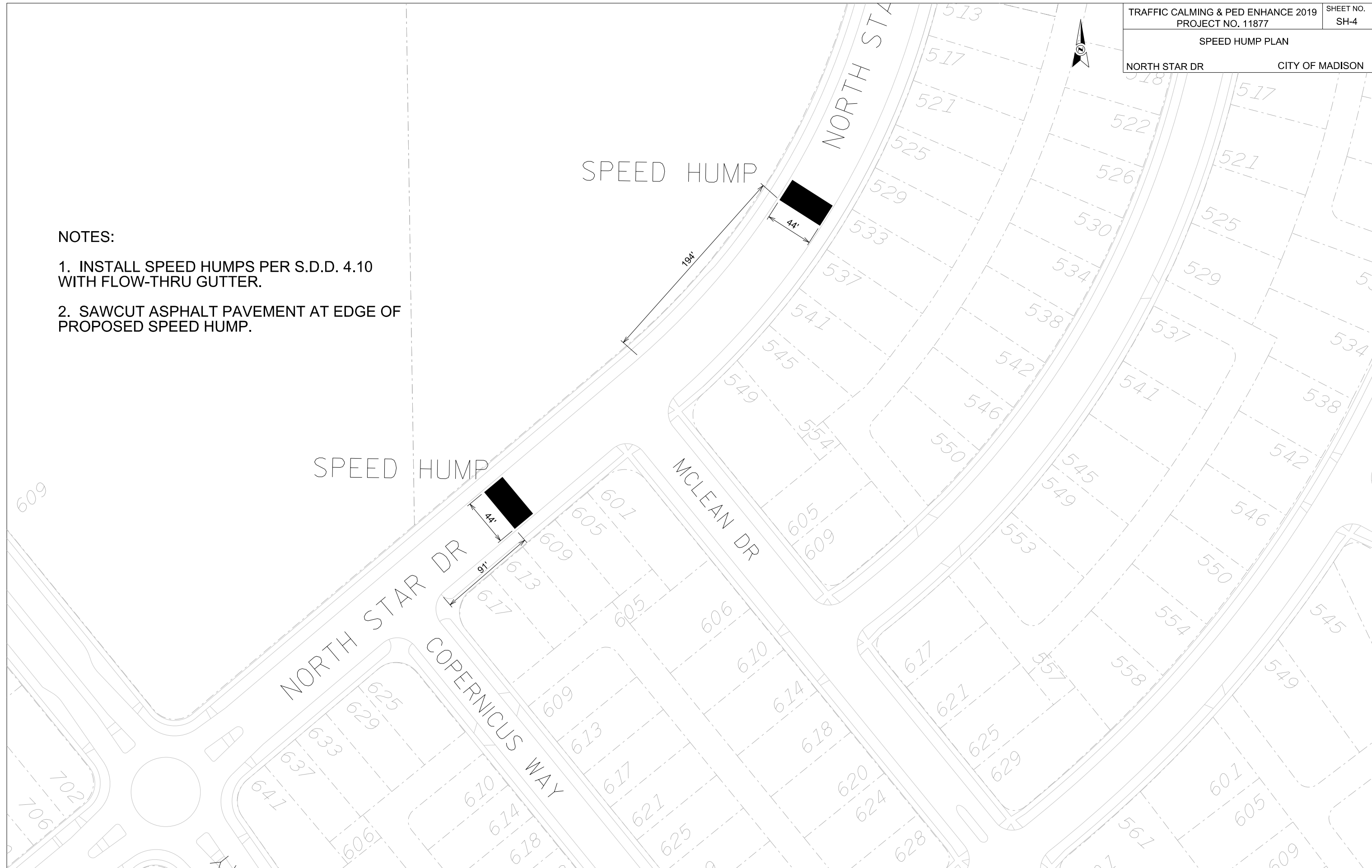

PLOT SCALE:

PLOT NAME:

REV. DATE:

ORIGINATOR: CITY OF MADISON, TRAFFIC ENG. DIV.

SPEED HUMP PLAN

NORTH STAR DR

CITY OF MADISON



ARIES WAY

6011 6015 6019 6023 6027 6031 6035 6039

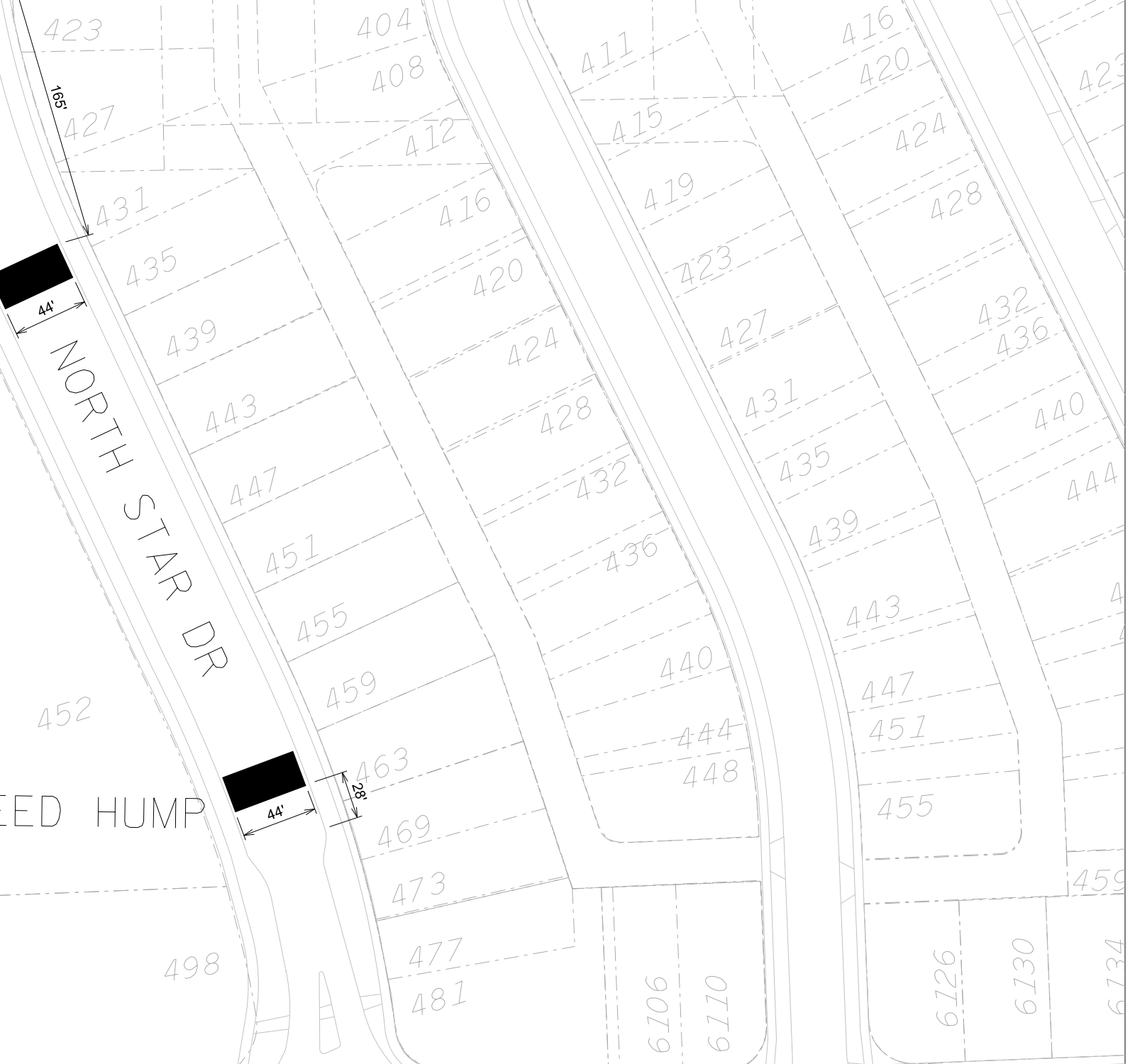

SPEED HUMP

SPEED HUMP

NOTES:

- 1. INSTALL SPEED HUMPS PER S.D.D. 4.10 WITH FLOW-THRU GUTTER.
- 2. SAWCUT ASPHALT PAVEMENT AT EDGE OF PROPOSED SPEED HUMP.

PLOT SCALE:

PLOT NAME:

REV. DATE:

ORIGINATOR: CITY OF MADISON, TRAFFIC ENG. DIV.

FINAL FIELD LAYOUT TO BE APPORVED BY TRAFFIC ENGINEERING.  
 CONTACT MARK WINTER 266-6543 DURING BEFORE APPLYING THERMOPLASTIC TO PAVEMENT.

## Typical Layouts for Bike Markings Using Green Preformed Thermoplastic

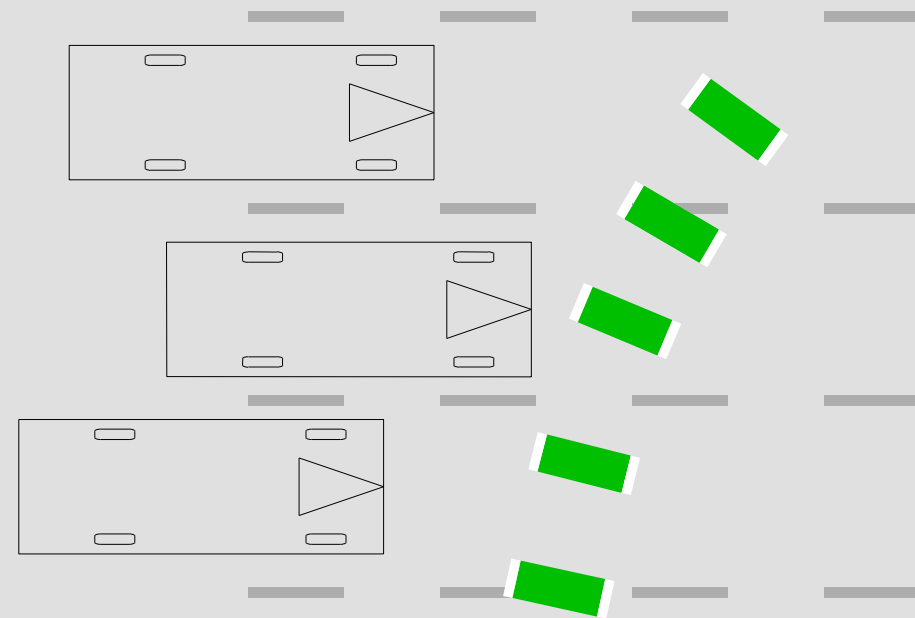

MARKING A BIKE LANE INTERSECTION TURNING MANUVER

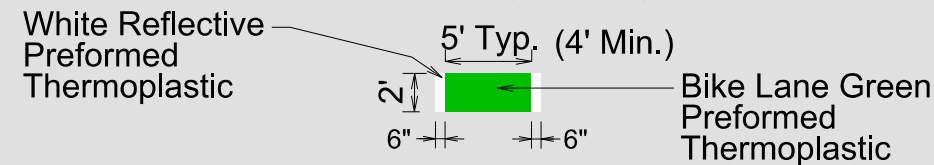

Spacing varied to avoid wheel tracks.

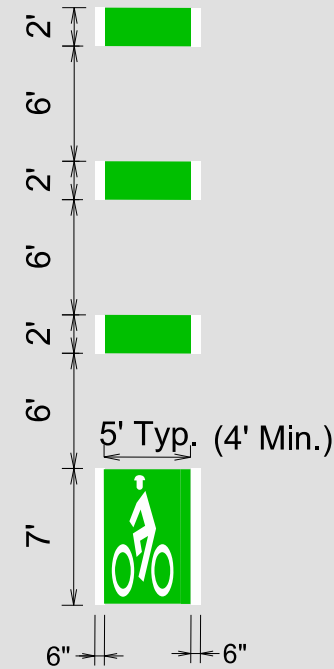

MARKING A BIKE LANE INTERSECTION APPROACH

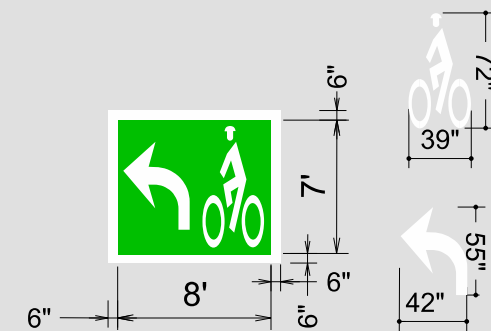

MARKING A LEFT TURN BOX

PLOT SCALE:

PLOT NAME:

REV. DATE:

ORIGINATOR: CITY OF MADISON, TRAFFIC ENG. DIV.

FINAL FIELD LAYOUT TO BE APPORVED BY TRAFFIC ENGINEERING.  
 CONTACT MARK WINTER 266-6543 DURING BEFORE APPLYING THERMOPLASTIC TO PAVEMENT.

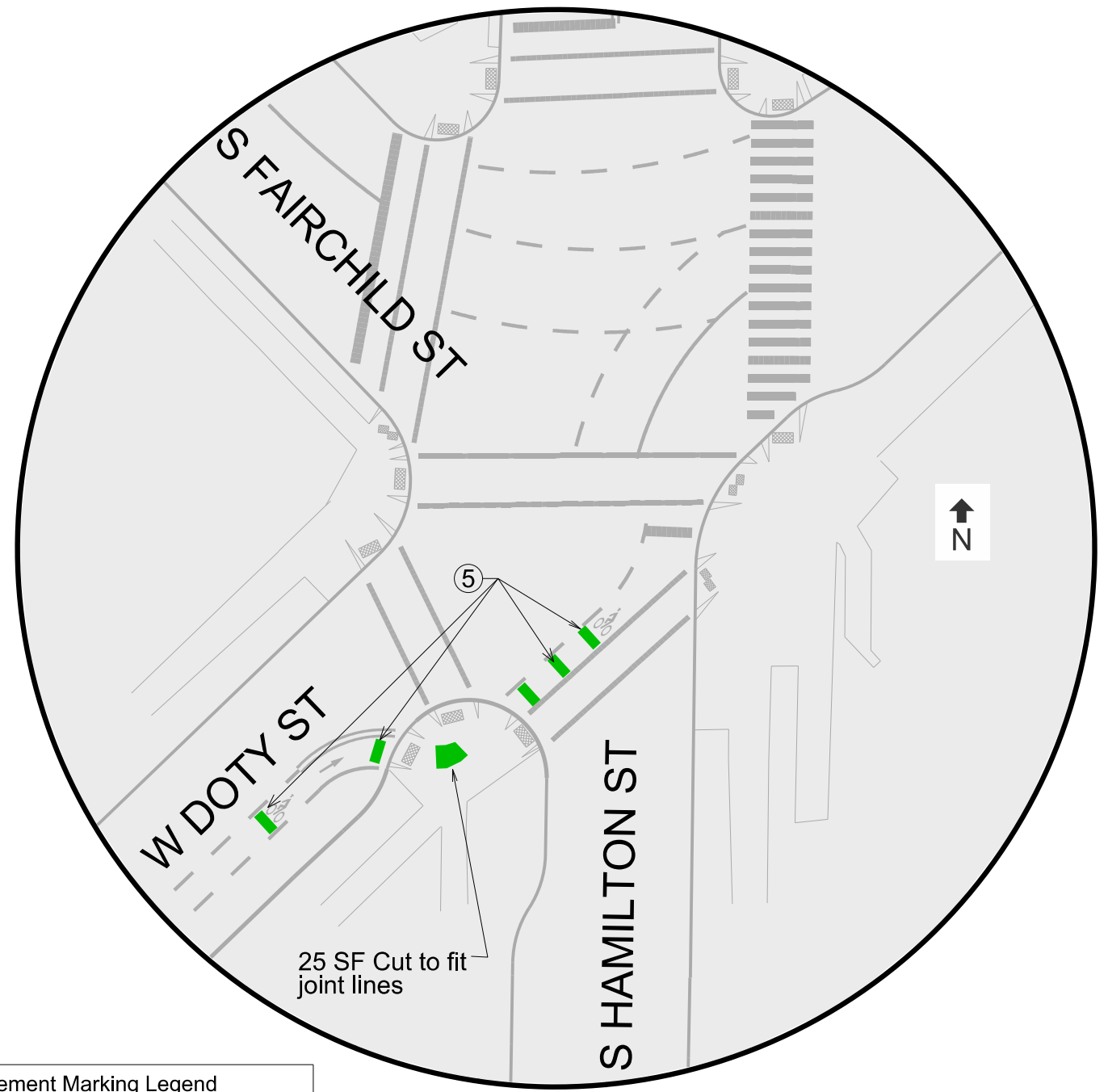
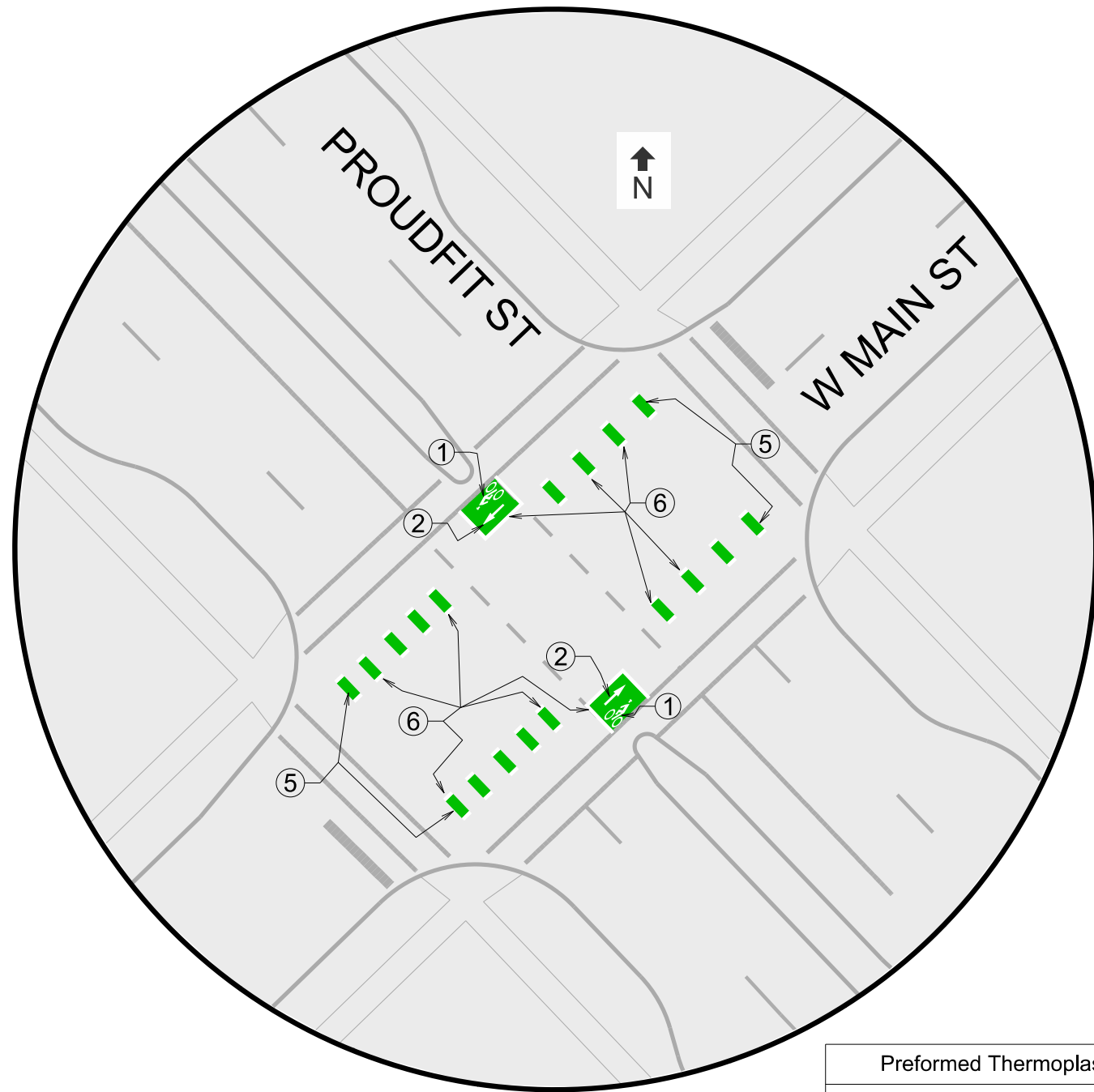

Preformed Thermoplastic Pavement Marking Legend	
①	White BIKE Symbol with Bike Lane Green Background
②	White STRAIGHT ARROW with Bike Lane Green Background
③	White LEFT ARROW with Bike Lane Green Background
④	White RIGHT ARROW with Bike Lane Green Background
⑤	Bike Lane Green - 2' x 5' (or as noted)
⑥	6-Inch White Retroreflective Line

PLOT SCALE:

PLOT NAME:

REV. DATE:

ORIGINATOR: CITY OF MADISON, TRAFFIC ENG. DIV.



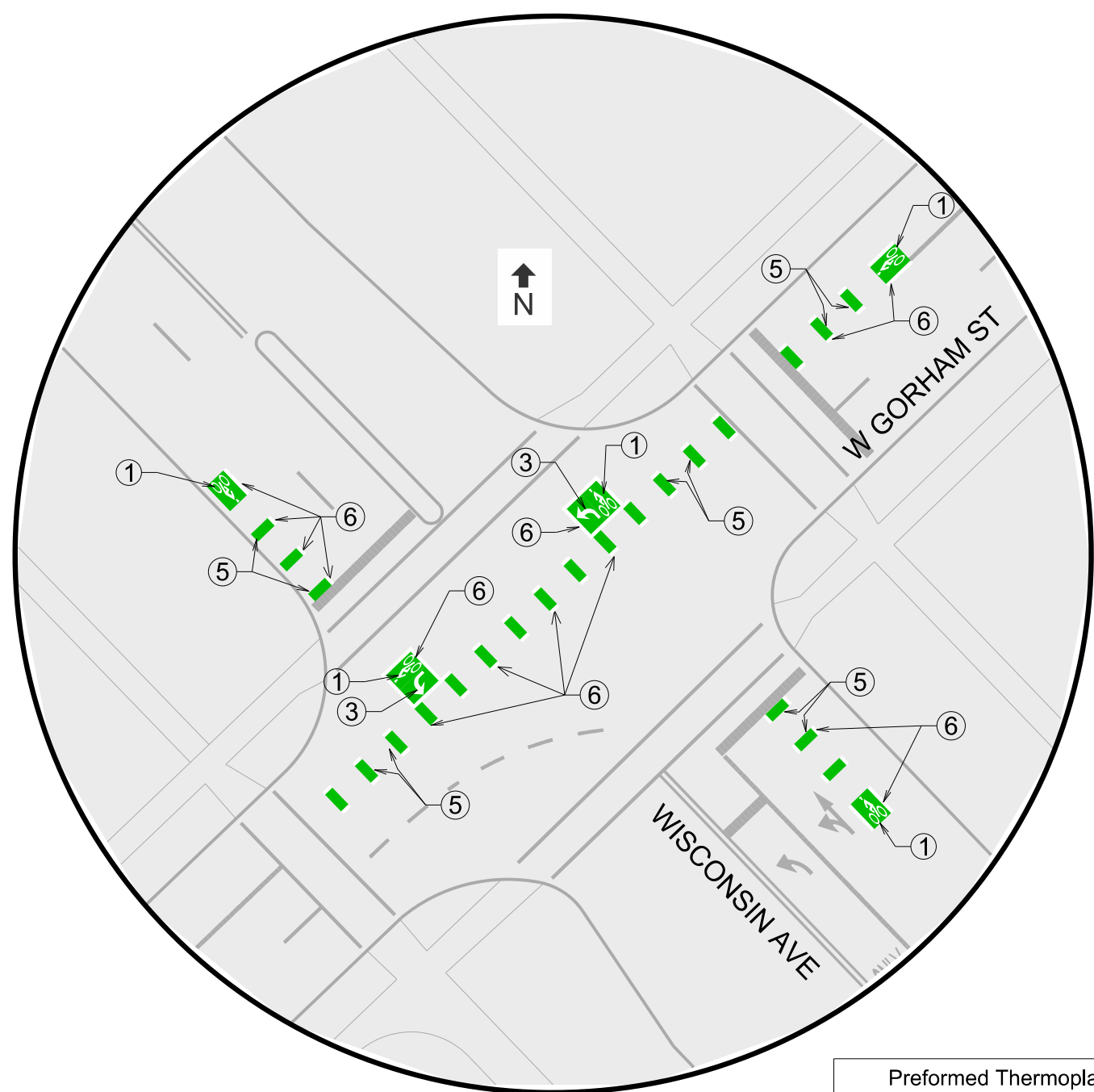

Preformed Thermoplastic Pavement Marking Legend	
①	White BIKE Symbol with Bike Lane Green Background
②	White STRAIGHT ARROW with Bike Lane Green Background
③	White LEFT ARROW with Bike Lane Green Background
④	White RIGHT ARROW with Bike Lane Green Background
⑤	Bike Lane Green - 2' x 5' (or as noted)
⑥	6-Inch White Retroreflective Line

PLOT SCALE:  
 PLOT NAME:  
 REV. DATE:  
 ORIGINATOR: CITY OF MADISON, TRAFFIC ENG. DIV.

PLOT SCALE:

PLOT NAME:

REV. DATE:

ORIGINATOR: CITY OF MADISON, TRAFFIC ENG. DIV.

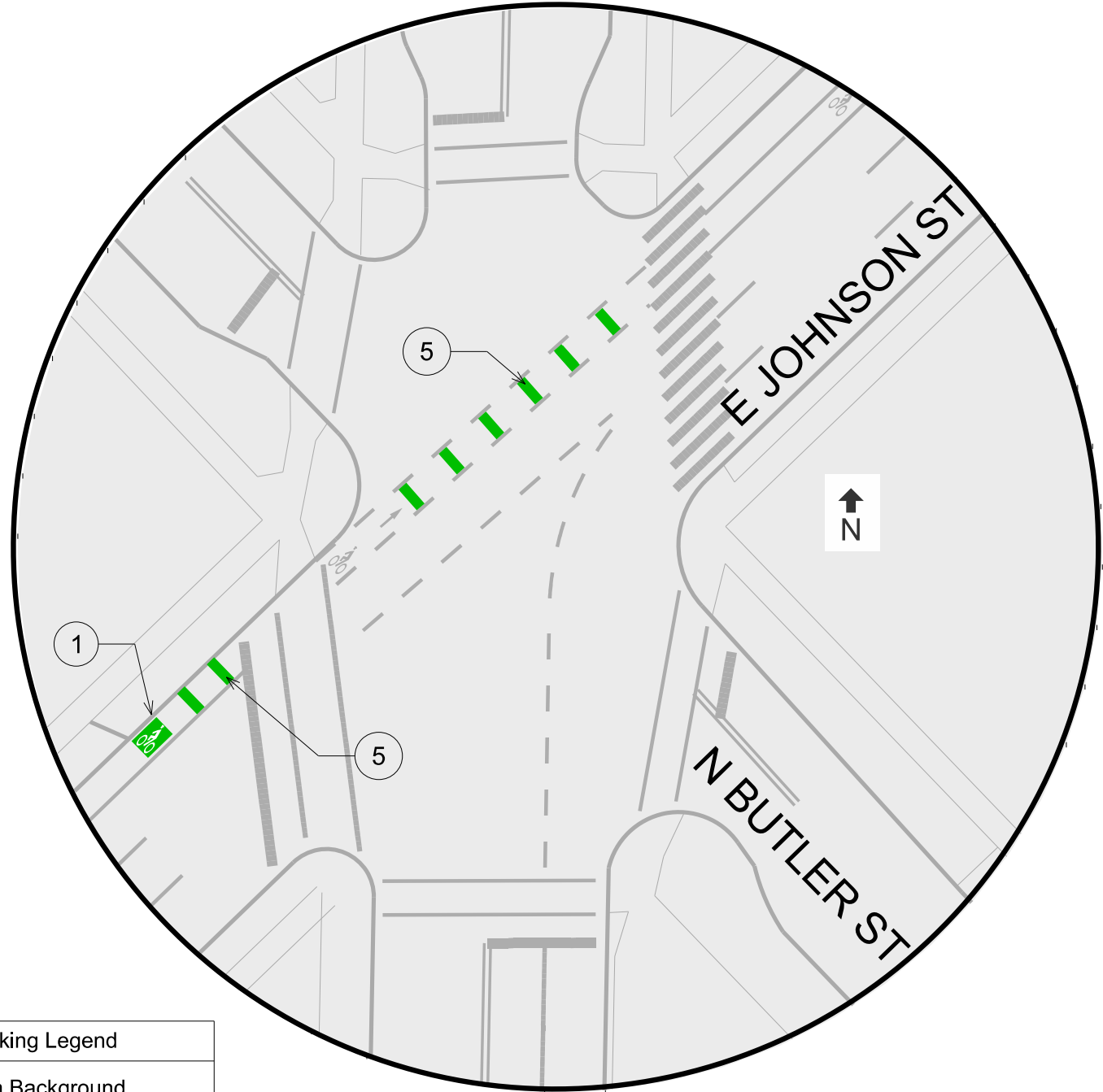
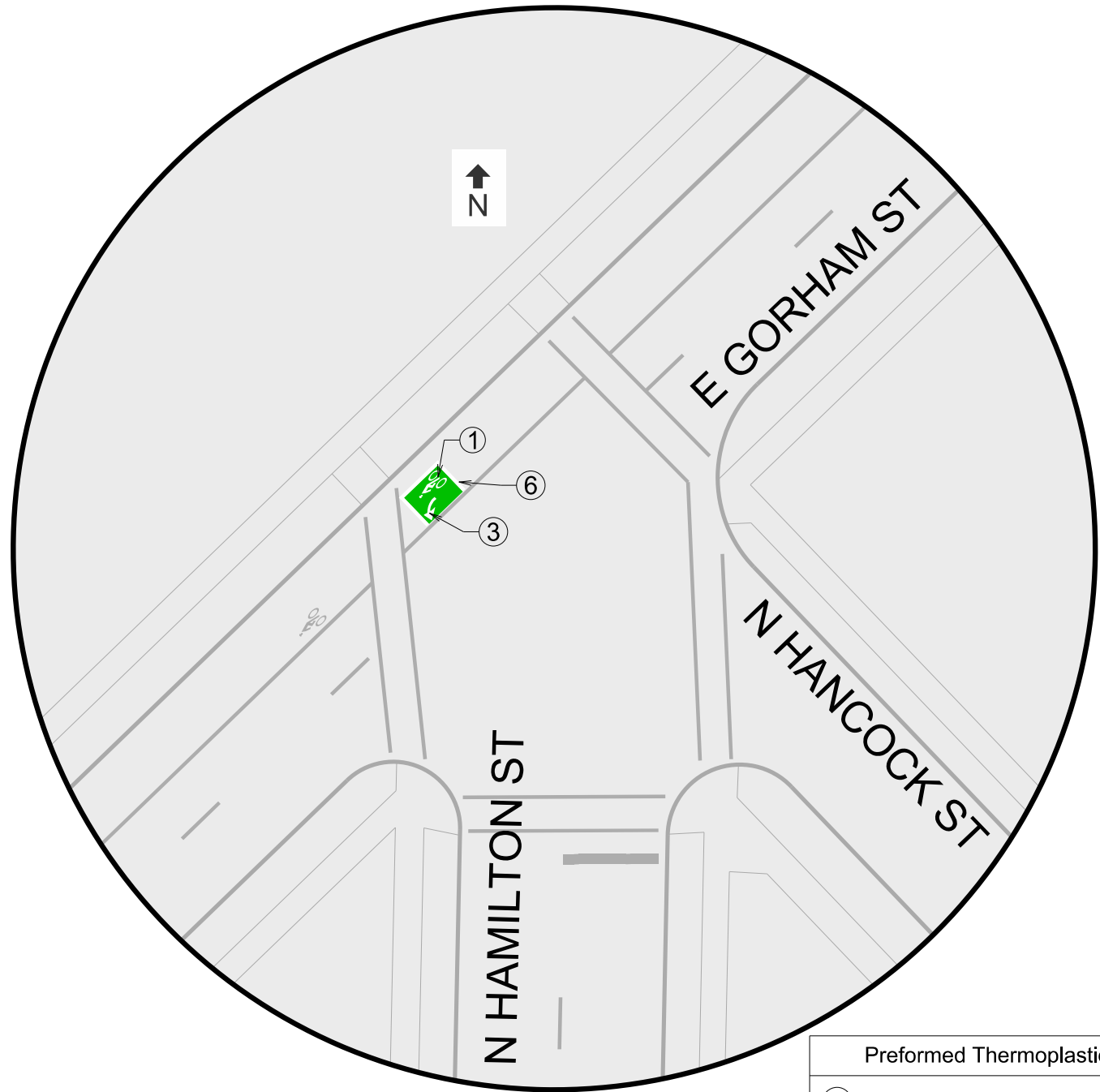

Preformed Thermoplastic Pavement Marking Legend	
①	White BIKE Symbol with Bike Lane Green Background
②	White STRAIGHT ARROW with Bike Lane Green Background
③	White LEFT ARROW with Bike Lane Green Background
④	White RIGHT ARROW with Bike Lane Green Background
⑤	Bike Lane Green - 2' x 5' (or as noted)
⑥	6-Inch White Retroreflective Line

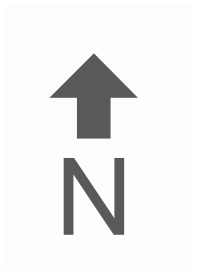
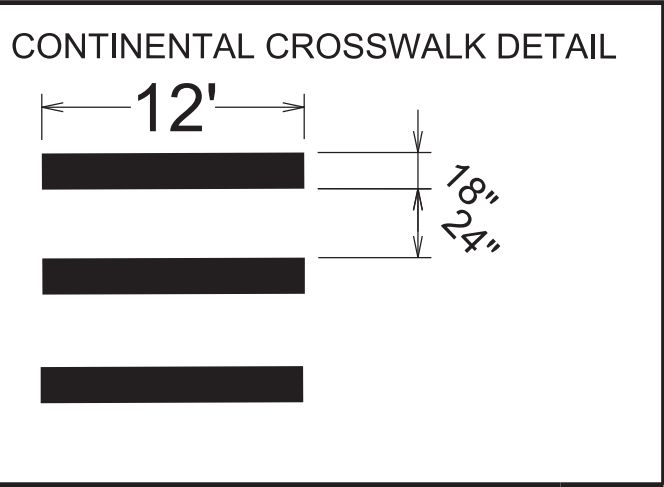

Grind off existing 6" crosswalk and install continental crosswalk

2824

S Marquette St

Atwood Ave

Elmside Blvd

2817

2821

2827

2907

PLOT SCALE:  
PLOT NAME:  
REV. DATE:  
ORIGINATOR: CITY OF MADISON, TRAFFIC ENG. DIV.

- NOTES:
1. ALL CURB & GUTTER ON THE ISLANDS SHALL BE TYPE 'E' PER S.D.D. 3.08
  2. ALL ISLANDS SHALL HAVE CONCRETE MOUNTABLE NOSES PER S.D.D. 3.13
  3. INTERIOR OF ISLANDS SHALL BE 7" STAMPED & COLORED CONCRETE (6"X6" COBBLESTONE, NATURAL BARK)
  4. SAWCUT EXISTING PAVEMENT AT PROPOSED EDGE OF GUTTER. TAKE CARE TO NOT DAMAGE PAVEMENT BEYOND THAT POINT.
  5. CONTRACTORS SHALL COORDINATE WITH TRAFFIC ENGINEERING TO LAYOUT ISLANDS IN THE FIELD



PLOT SCALE:

PLOT NAME:

REV. DATE:

ORIGINATOR: CITY OF MADISON, TRAFFIC ENG. DIV.

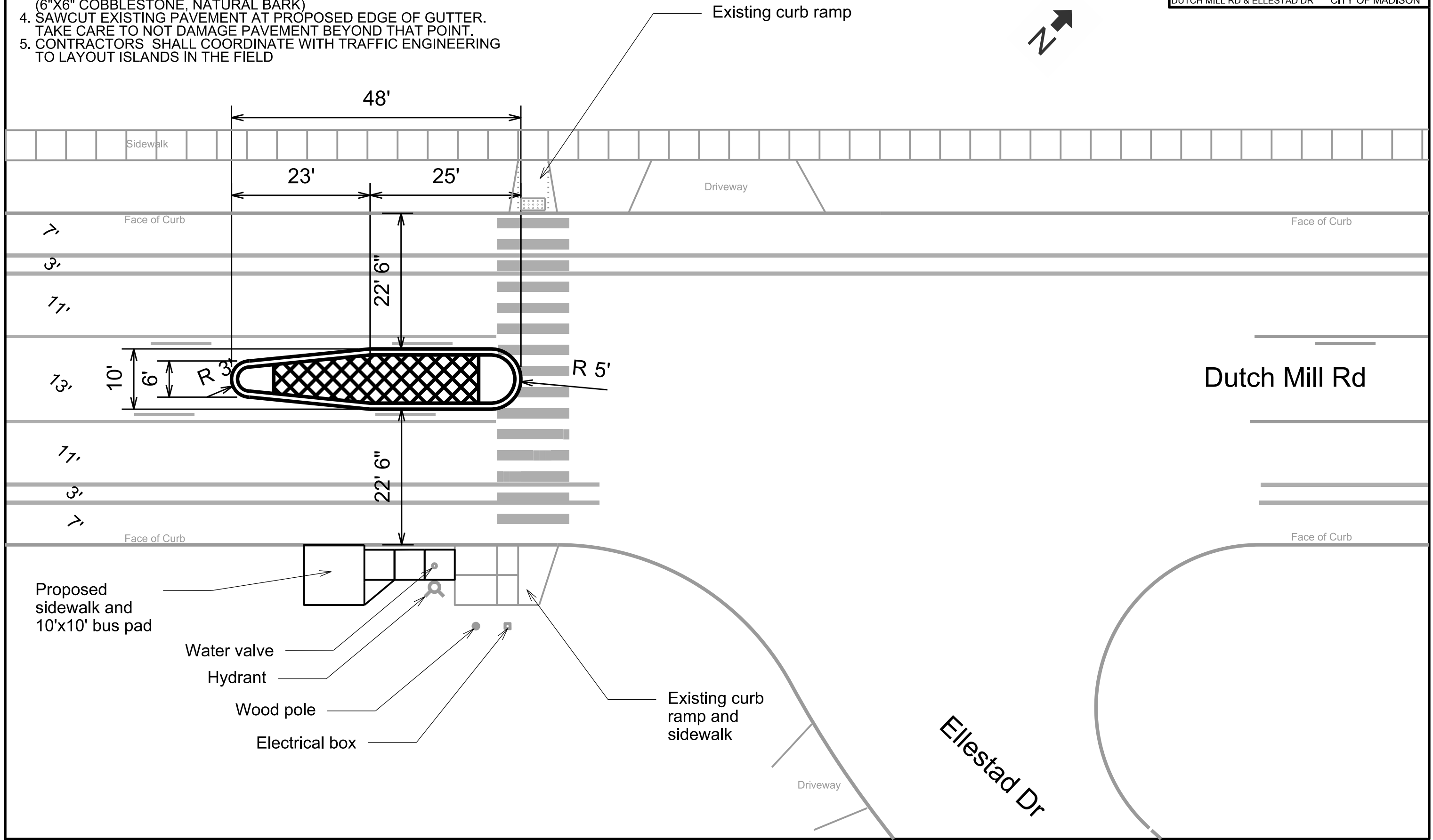



SCALE: 1" = 30'

**GENERAL NOTES**

1. REMOVE EXISTING PAVEMENT MARKINGS WITHIN THE INTERSECTION.
  2. CONTRACTOR SHALL INSTALL EPOXY PAVEMENT MARKINGS AS SHOWN ON THE PLAN AND PER CITY OF MADISON STANDARD DETAIL DRAWING 6.38.
  3. TE CREWS TO INSTALL RRFB AT NEW CONTINENTAL CROSSING.
- CONTACT: CITY OF MADISON - TRAFFIC ENGINEERING, GRETCHEN AVILES PINEIRO (266-4899).

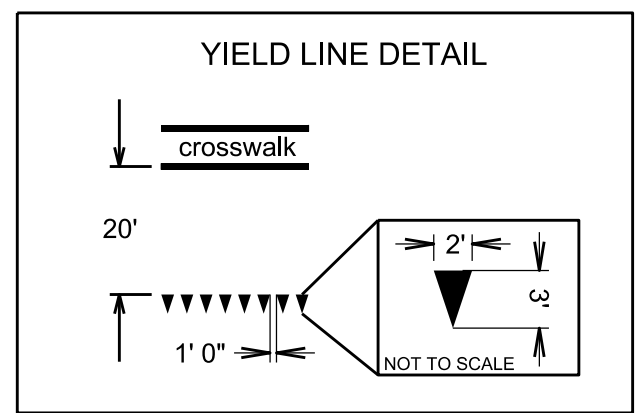
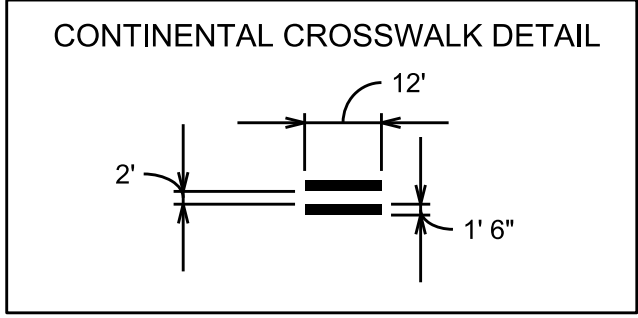
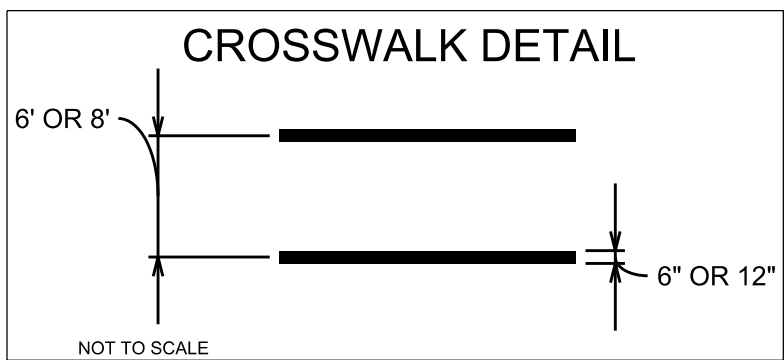

INSTALL EPOXY YIELD PAVEMENT MARKINGS

INSTALL 12" EPOXY PAVEMENT MARKINGS 8' WIDE CROSSWALK

REMOVE EXISTING 6" SKIPS AND 6" LINES MARKED WITHIN THE INTERSECTION AND NEW CROSSWALKS

INSTALL EPOXY CONTINENTAL CROSSWALK PAVEMENT MARKINGS

INSTALL 6" EPOXY PAVEMENT MARKINGS 6' WIDE CROSSWALK

INSTALL 24" STOP BAR

INSTALL EPOXY YIELD PAVEMENT MARKINGS

PLOT SCALE:  
PLOT NAME:  
REV. DATE:  
ORIGINATOR: CITY OF MADISON, TRAFFIC ENG. DIV.

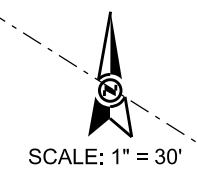

PLOT SCALE:  
PLOT NAME:  
REV. DATE:  
ORIGINATOR: CITY OF MADISON, TRAFFIC ENG. DIV.

**GENERAL NOTES**

- 1. CONTRACTOR SHALL REMOVE EXISTING NEW WASHBURN WAY CROSSWALK PAVEMENT MARKINGS AND EXISTING LANE MARKINGS ON S GAMMON RD AT THE INTERSECTION.
  - 2. CONTRACTOR SHALL INSTALL NEW PAVEMENT MARKINGS FOR CROSSINGS AS SHOWN.
- CONTACT: CITY OF MADISON - TRAFFIC ENGINEERING, GRETCHEN AVILES PINEIRO (266-4899).

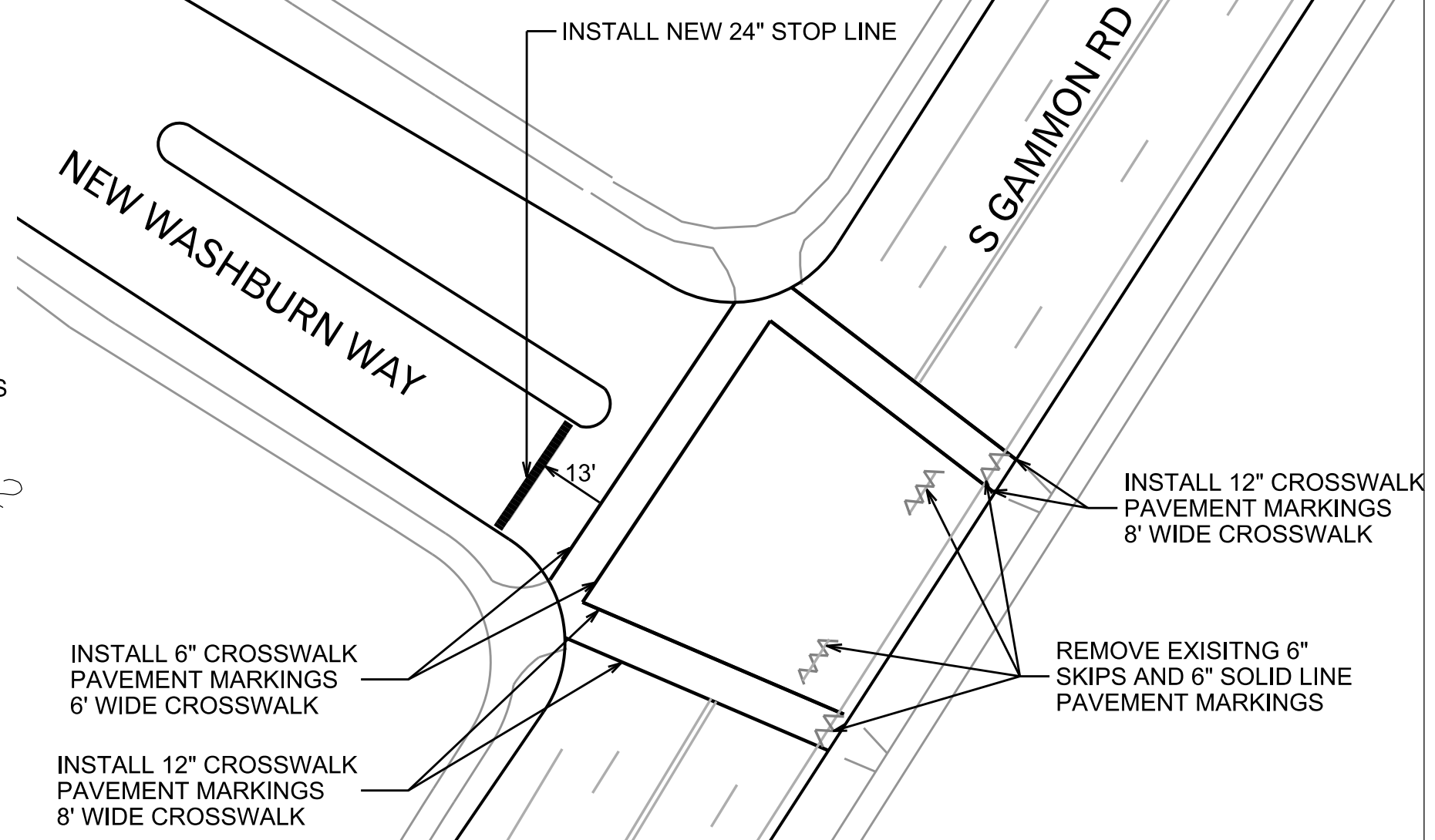
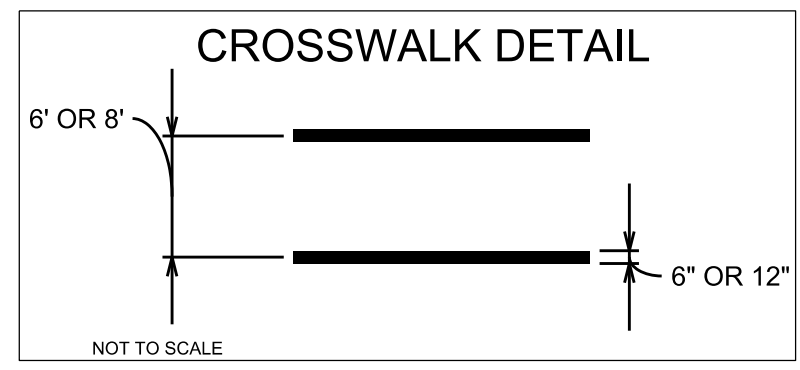



SCALE: 1" = 30'

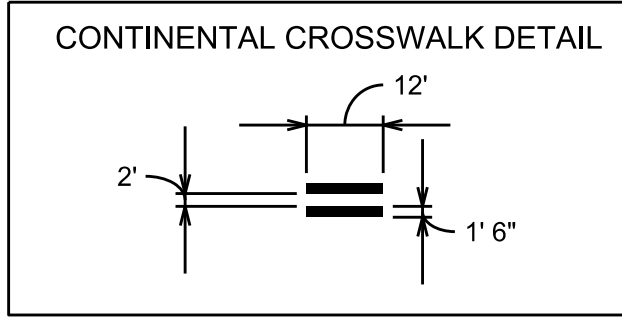

GENERAL NOTES

1. CONTRACTOR SHALL REMOVE EXISTING PAVEMENT MARKING ON THE WEST LEG CROSSING.

2. CONTRACTOR SHALL INSTALL EPOXY CONTINENTAL PAVEMENT MARKINGS AS SHOWN PER CITY OF MADISON STANDARD DETAIL DRAWING 6.38.

3. TE CREWS TO INSTALL RRFB AT NEW CONTINENTAL CROSSING.

CONTACT: CITY OF MADISON - TRAFFIC ENGINEERING, GRETCHEN AVILES PINEIRO (266-4899).

REMOVE EXISTING 6" CROSSWALK PAVEMENT MARKINGS  
REMOVE 12' OF EXISTING 6" BIKE LANE PAVEMENT MARKINGS AT THE NEW CONTINENTAL CROSSING

INSTALL NEW EPOXY CONTINENTAL PAVEMENT MARKINGS

FORWARD DR

SCHROEDER RD

HATHAWAY DR

PLOT SCALE:

PLOT NAME:

REV. DATE:

ORIGINATOR: CITY OF MADISON, TRAFFIC ENG. DIV.

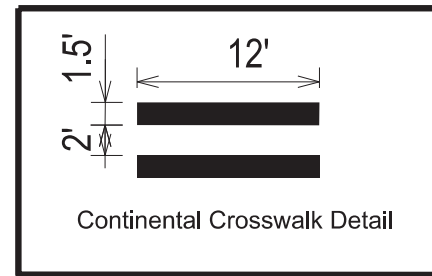

PLOT SCALE:

PLOT NAME:

REV. DATE:

ORIGINATOR: CITY OF MADISON, TRAFFIC ENG. DIV.

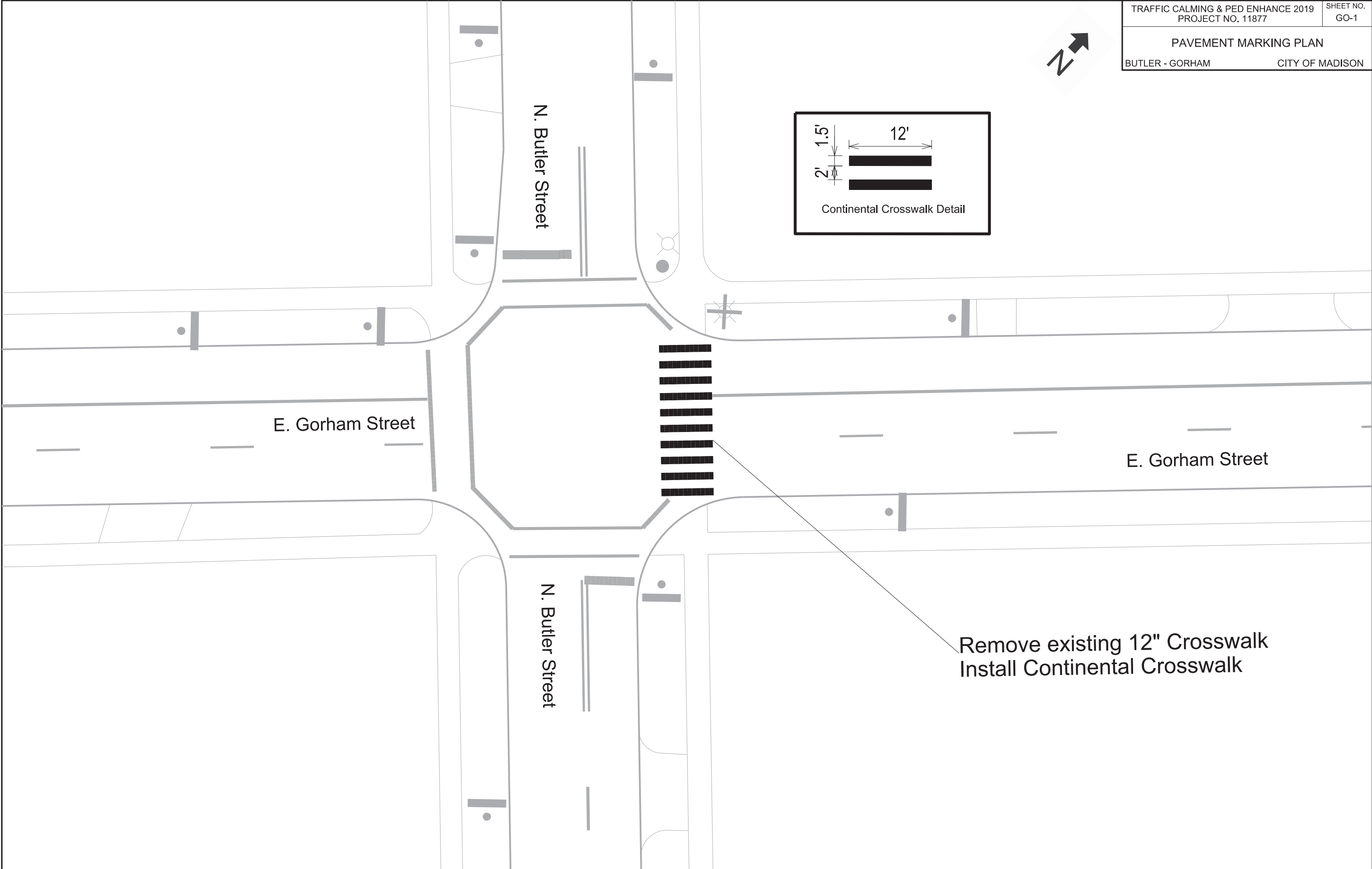

Remove existing 12" Crosswalk  
Install Continental Crosswalk



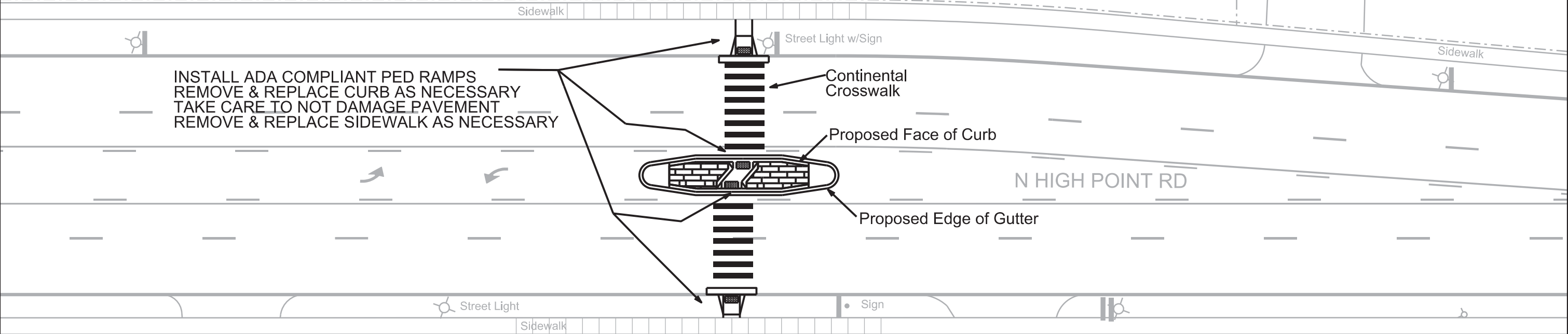
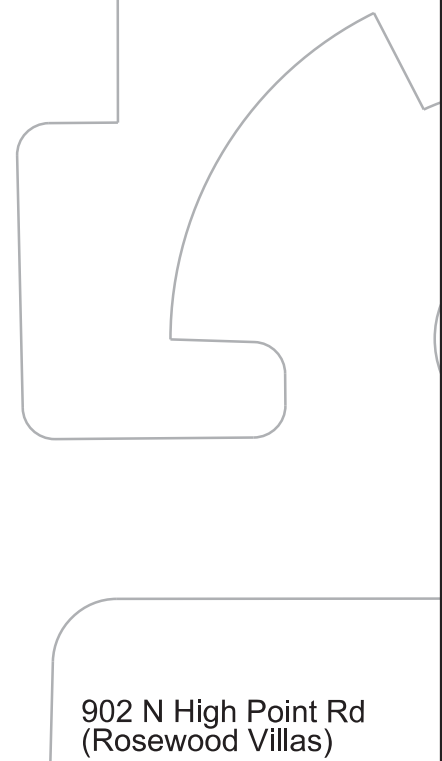
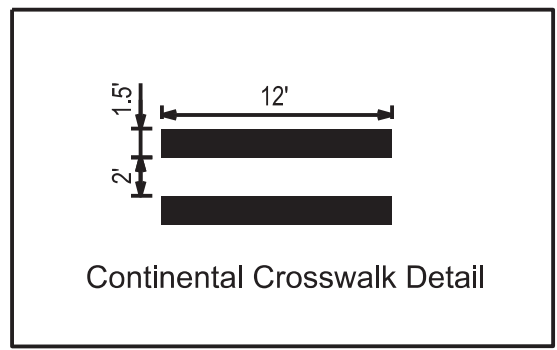
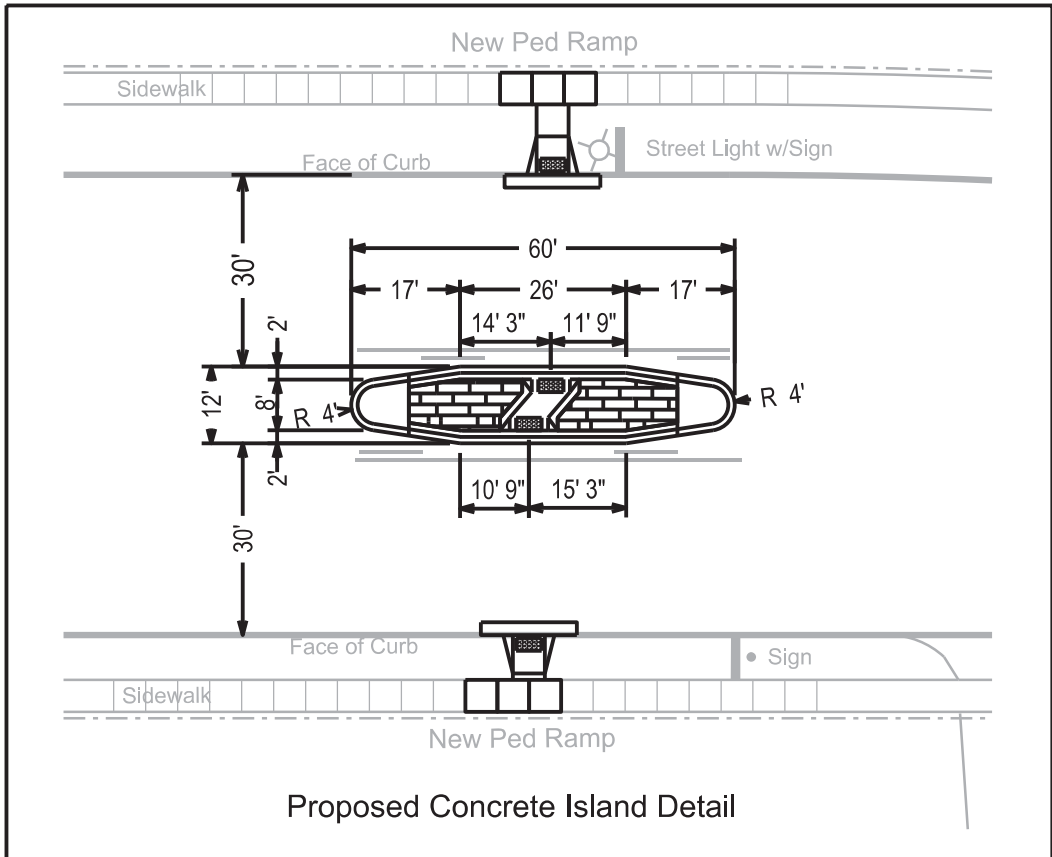

INSTALL ADA COMPLIANT PED RAMPS  
 REMOVE & REPLACE CURB AS NECESSARY  
 TAKE CARE TO NOT DAMAGE PAVEMENT  
 REMOVE & REPLACE SIDEWALK AS NECESSARY

- NOTES:**
1. ALL CURB & GUTTER ON THE ISLANDS SHALL BE TYPE 'E' PER S.D.D. 3.08
  2. ALL ISLANDS SHALL HAVE CONCRETE MOUNTABLE NOSES PER S.D.D. 3.13
  3. INTERIOR OF ISLANDS SHALL BE 7" STAMPED & COLORED CONCRETE (6"X6" COBBLESTONE, NATURAL BARK)
  4. SAWCUT EXISTING PAVEMENT AT PROPOSED EDGE OF GUTTER. TAKE CARE TO NOT DAMAGE PAVEMENT BEYOND THAT POINT.
  5. CONTRACTORS SHALL COORDINATE WITH TRAFFIC ENGINEERING TO LAYOUT ISLANDS IN THE FIELD

PLOT SCALE:  
 PLOT NAME:  
 REV. DATE:  
 ORIGINATOR: CITY OF MADISON, TRAFFIC ENG. DIV.

PAVEMENT MARKING REMOVALS

MID TOWN RD & WOODS RD CITY OF MADISON

North ↑

WOODS RD

MID TOWN RD

REMOVE 6" WHITE CROSSWALK

REMOVE 6" SOLID LINE

REMOVE 6" SKIPS (5'X5')

REMOVE 4" DOUBLE YELLOW

REMOVE 6" SKIPS (2'X6')

REMOVE 6" SOLID LINE

REMOVE 6" WHITE CROSSWALK

REMOVE 6" SOLID LINE

REMOVE 6" SKIPS (5'X5')

REMOVE 4" DOUBLE YELLOW

REMOVE 6" SKIPS (2'X6')

62' DOUBLE YELLOW TO REMAIN  
(PAVEMENT WILL BE REMOVED FOR CONCRETE ISLAND)

61' DOUBLE YELLOW TO REMAIN  
(PAVEMENT WILL BE REMOVED FOR CONCRETE ISLAND)

PLOT SCALE:  
PLOT NAME:  
REV. DATE:  
ORIGINATOR: CITY OF MADISON, TRAFFIC ENG. DIV.

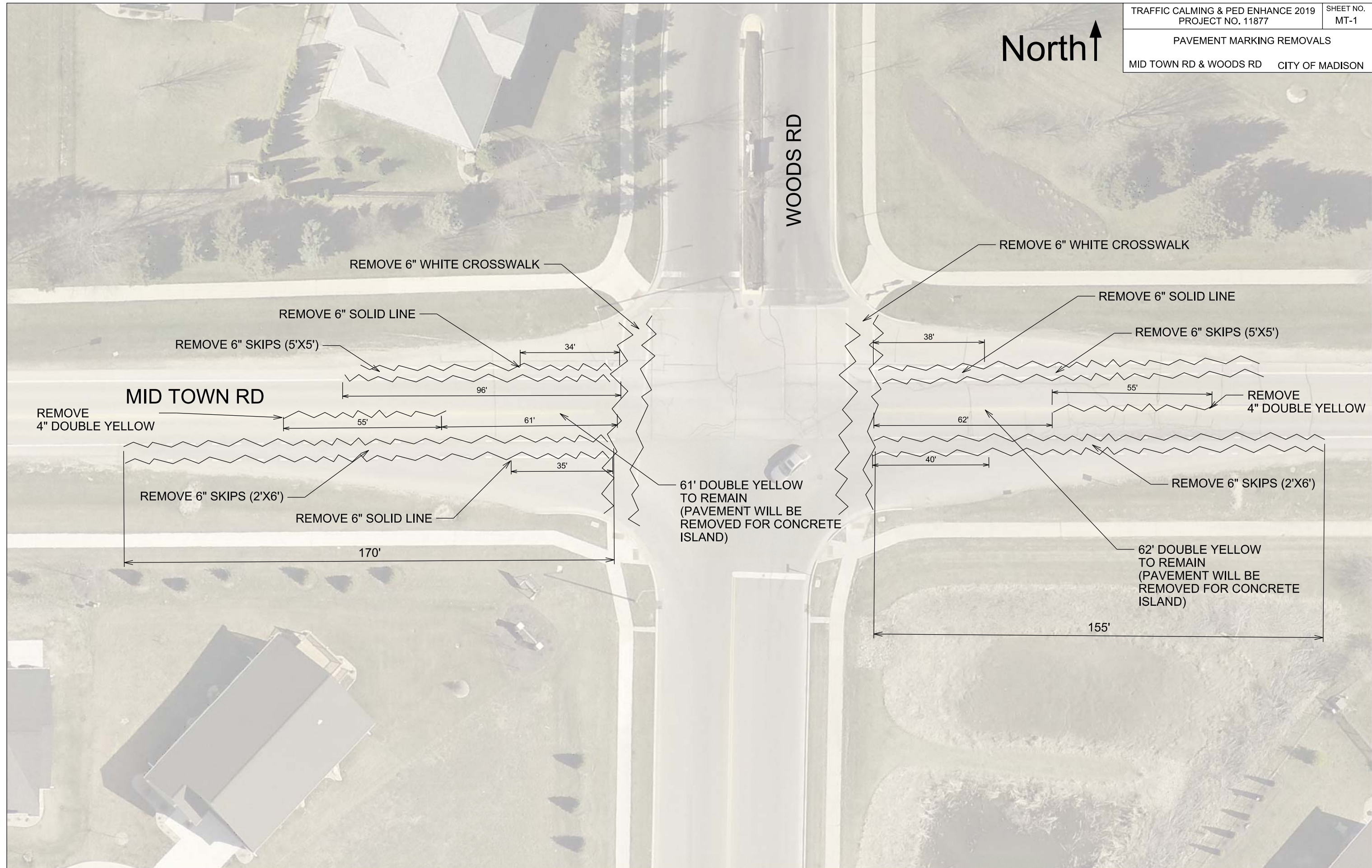

North ↑

WOODS RD

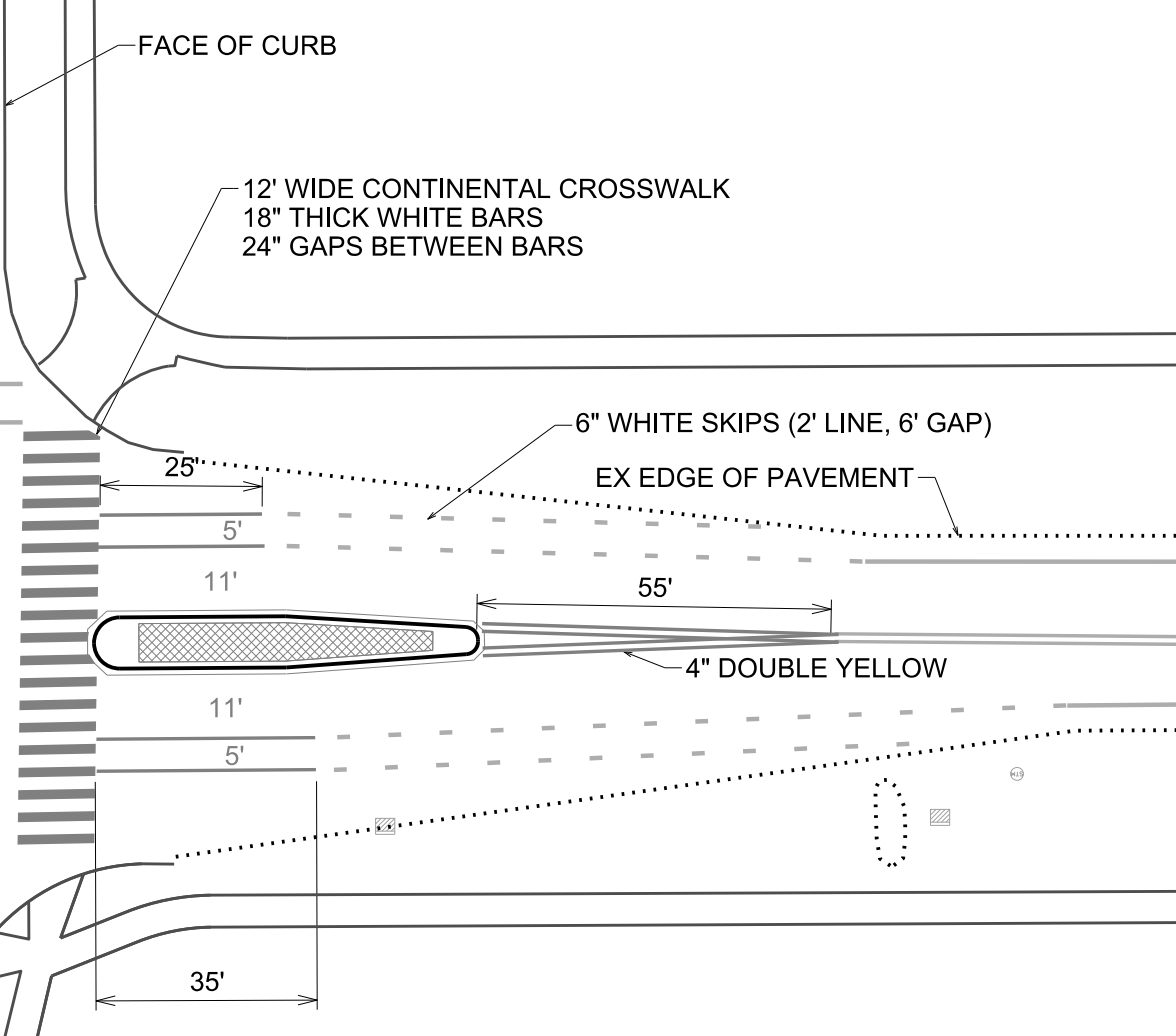
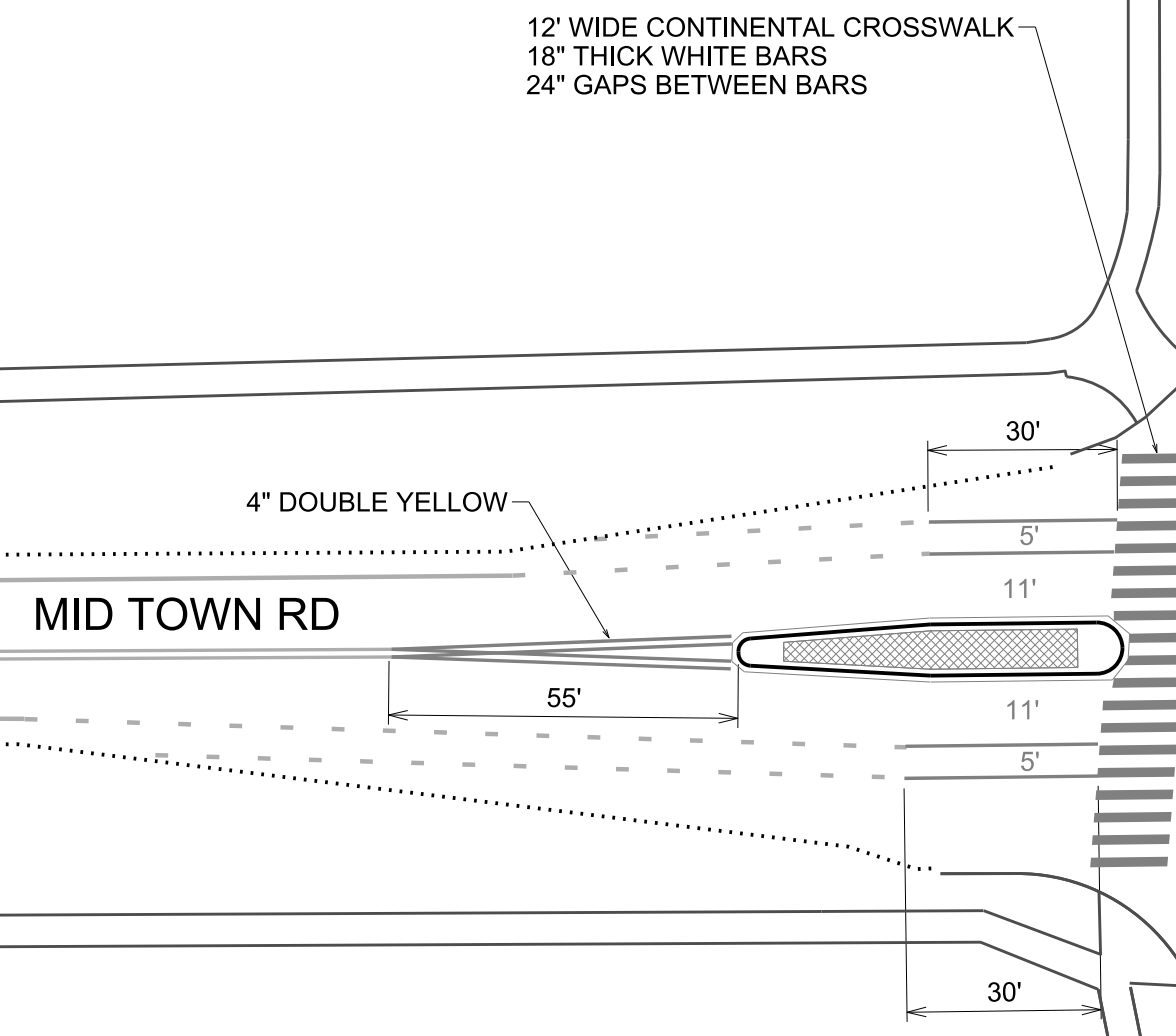

12' WIDE CONTINENTAL CROSSWALK  
18" THICK WHITE BARS  
24" GAPS BETWEEN BARS

FACE OF CURB

12' WIDE CONTINENTAL CROSSWALK  
18" THICK WHITE BARS  
24" GAPS BETWEEN BARS

4" DOUBLE YELLOW

MID TOWN RD

6" WHITE SKIPS (2' LINE, 6' GAP)

EX EDGE OF PAVEMENT

4" DOUBLE YELLOW

NOTES:

1. CURB & GUTTER ON ISLANDS SHALL BE TYPE 'E' PER S.D.D. 3.08
2. ISLANDS SHALL HAVE MOUNTABLE NOSES PER S.D.D. 3.13
3. INTERIOR OF ISLANDS SHALL BE 7" STAMPED & COLORED CONCRETE (6"X6" COBBLESTONE, NATURAL BARK)
4. SAWCUT EXISTING PAVEMENT AT PROPOSED EDGE OF GUTTER. TAKE CARE NOT TO DAMAGE PAVEMENT BEYOND THAT POINT.
5. CONTRACTORS SHALL COORDINATE TO HAVE TRAFFIC ENGINEERING LAYOUT ISLANDS IN FIELD (CALL 608-267-8725)
6. INSTALL PAVEMENT MARKINGS WITHIN 7 DAYS OF ISLAND CONSTRUCTION.
7. LANE WIDTHS ARE FROM CENTER OF MARKING OR FACE OF CURB
8. ALL EXISTING STORM STRUCTURES TO REMAIN

ISLAND DETAIL (ISLANDS HAVE SAME DIMENSIONS)

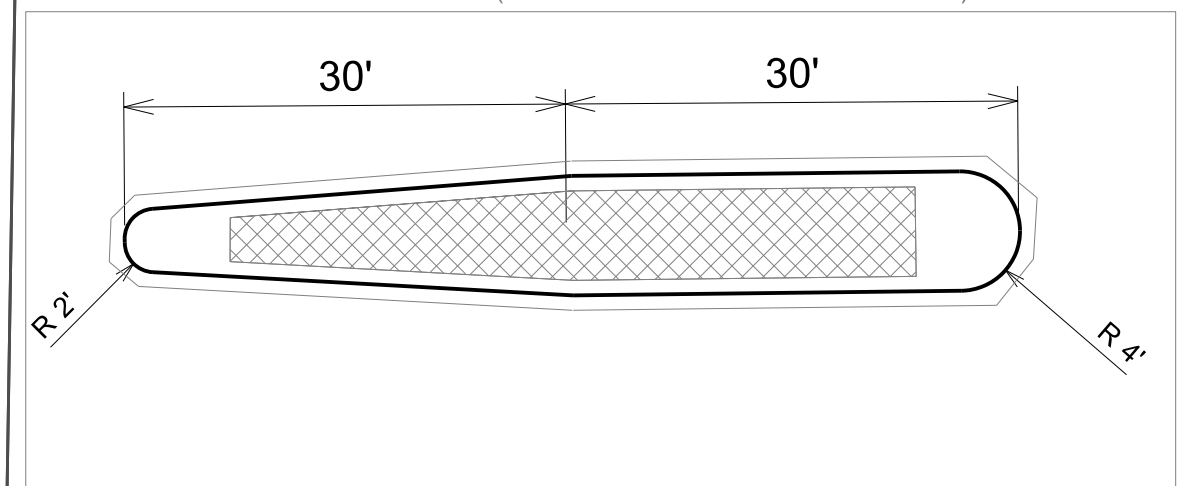

PLOT SCALE:

PLOT NAME:

REV. DATE:

ORIGINATOR: CITY OF MADISON, TRAFFIC ENG. DIV.

MARKING REMOVAL PLAN  
ODANA - SEGOE CITY OF MADISON

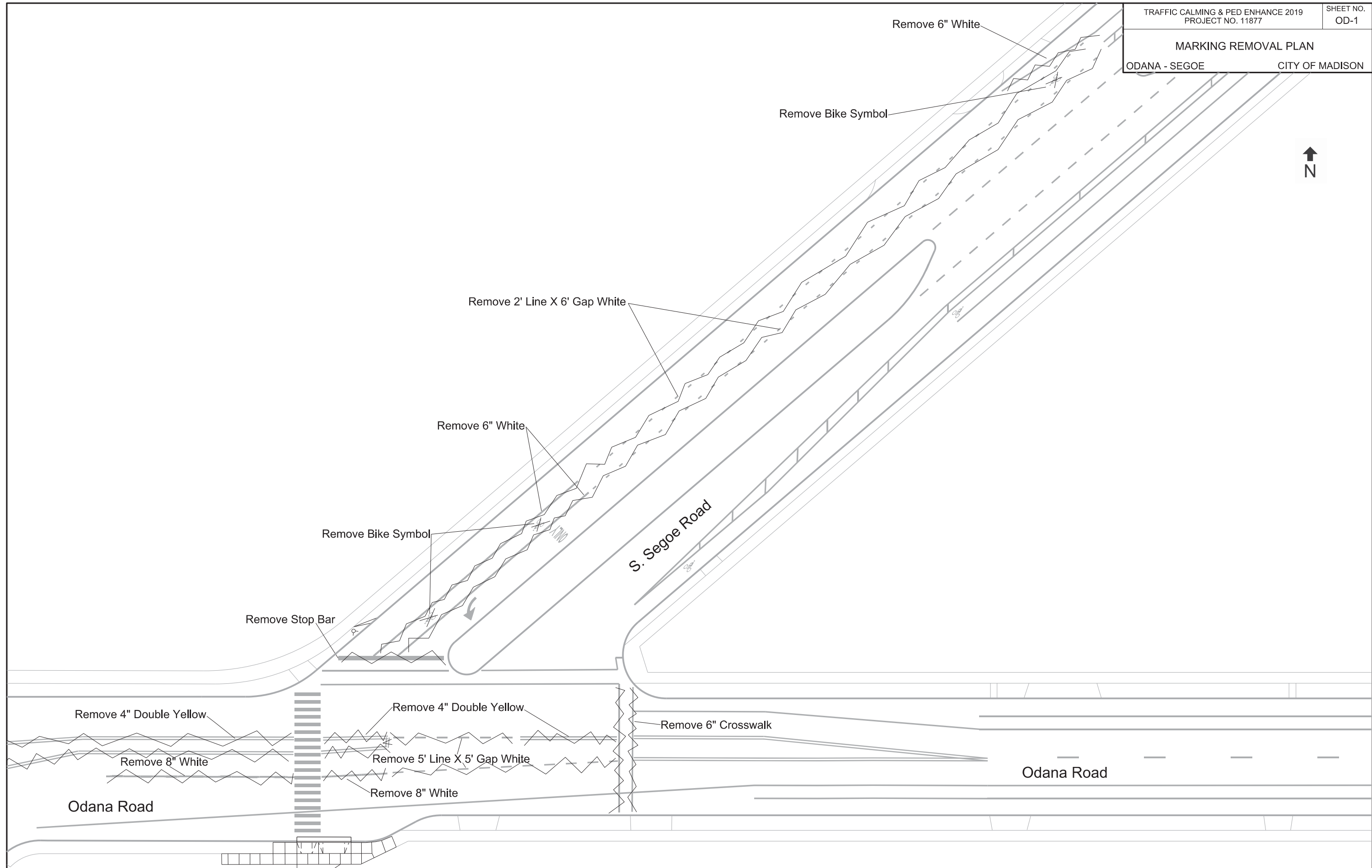

PLOT SCALE:  
PLOT NAME:  
REV. DATE:  
ORIGINATOR: CITY OF MADISON, TRAFFIC ENG. DIV.

PAVEMENT MARKING PLAN  
ODANA - SEGOE CITY OF MADISON

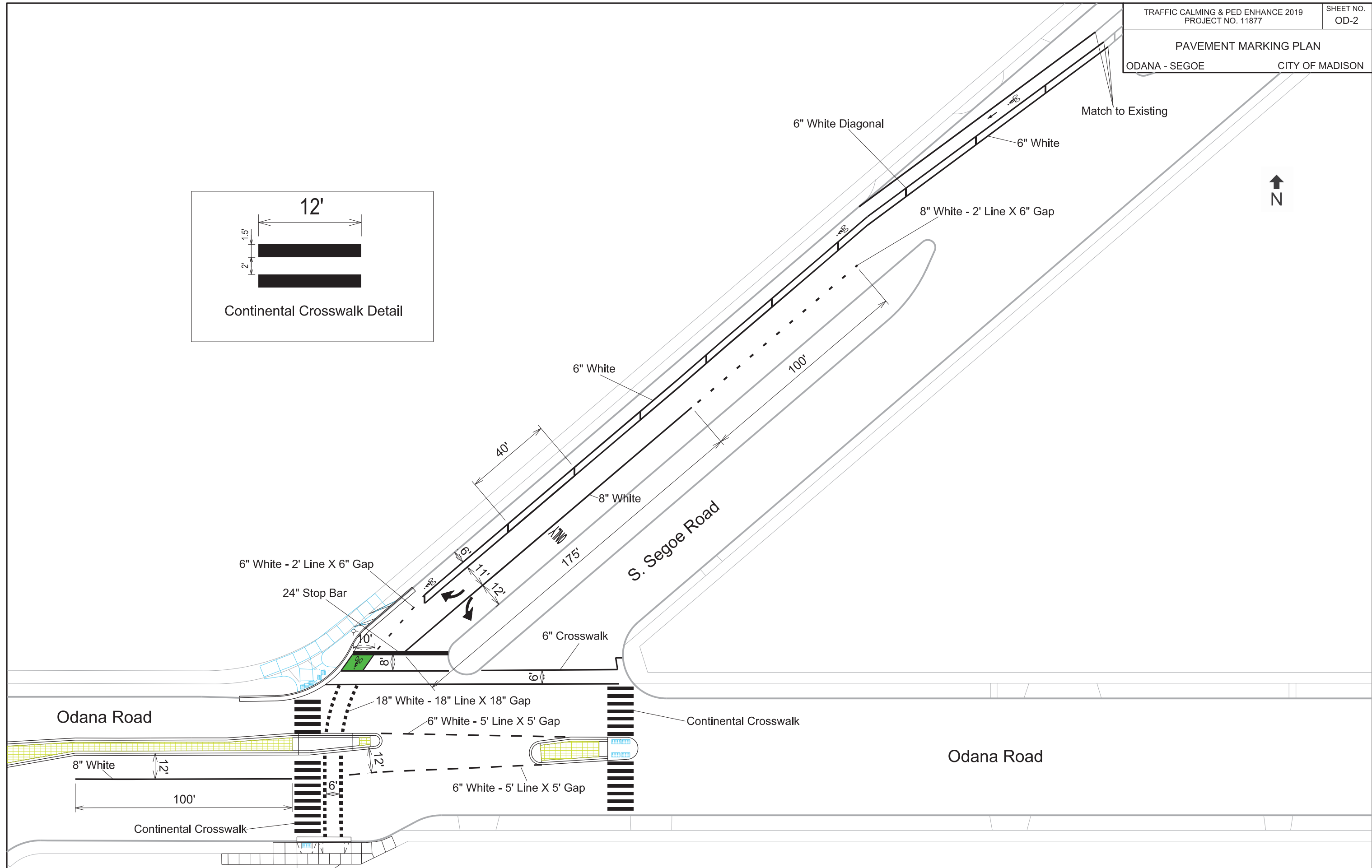
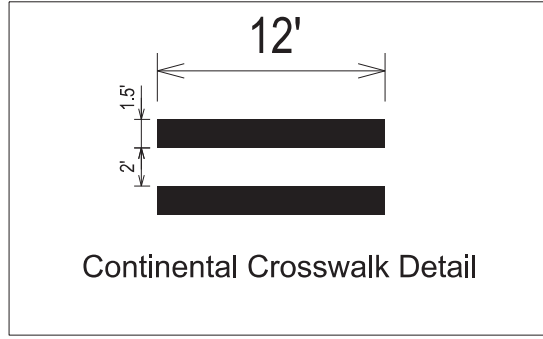

PLOT SCALE:  
PLOT NAME:  
REV. DATE:  
ORIGINATOR: CITY OF MADISON, TRAFFIC ENG. DIV.

GENERAL NOTES:

TS #1:  
1. INSTALL TYPE G BASE  
2. INSTALL 2-INCH PVC SCH 80 CONDUIT FROM TS1 TO TS2.

TS #2:  
1. INSTALL TYPE G BASE

TS #3:  
1. INSTALL LB-8 BASE

TS #4:  
1. INSTALL TYPE G BASE.

*Pole, Sign, RRFB, etc. installation to be installed by Traffic Engineering, contractor shall coordinate with Traffic Engineering on RRFB installation contact Mike Benzschawel at 266-9031 or TE shop at 266-4767*

ELECTRICAL AND SIGNING PLAN

PLOT SCALE:

PLOT NAME:

REV. DATE:

ORIGINATOR: CITY OF MADISON, TRAFFIC ENG. DIV.

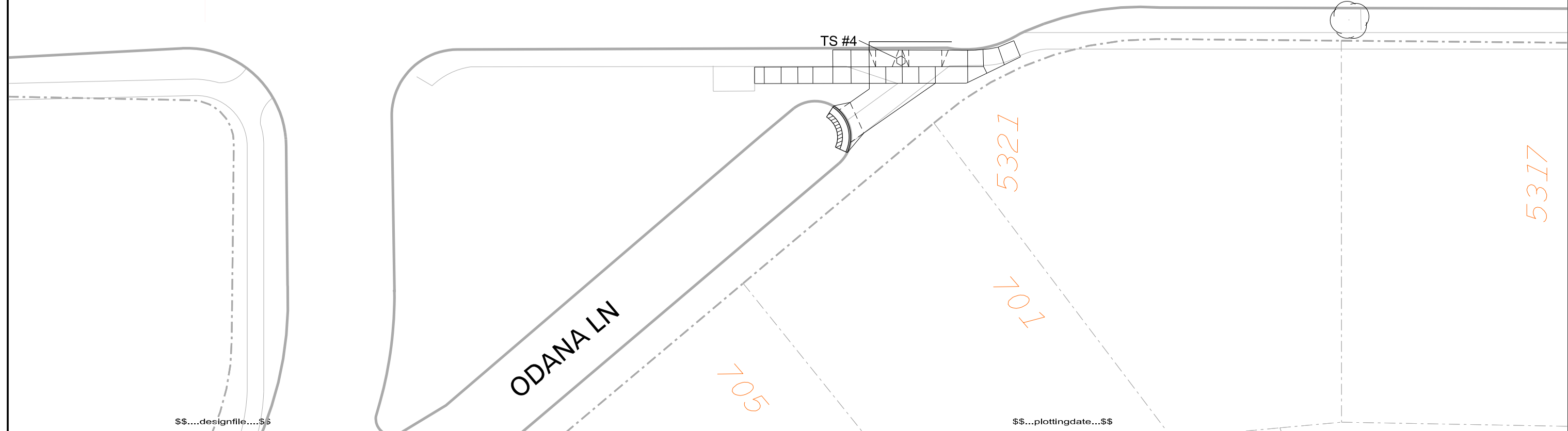
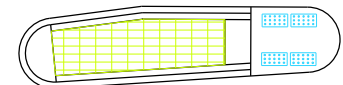
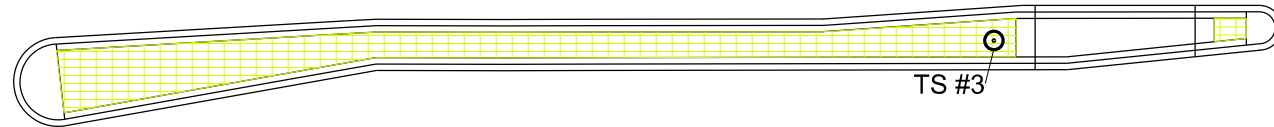
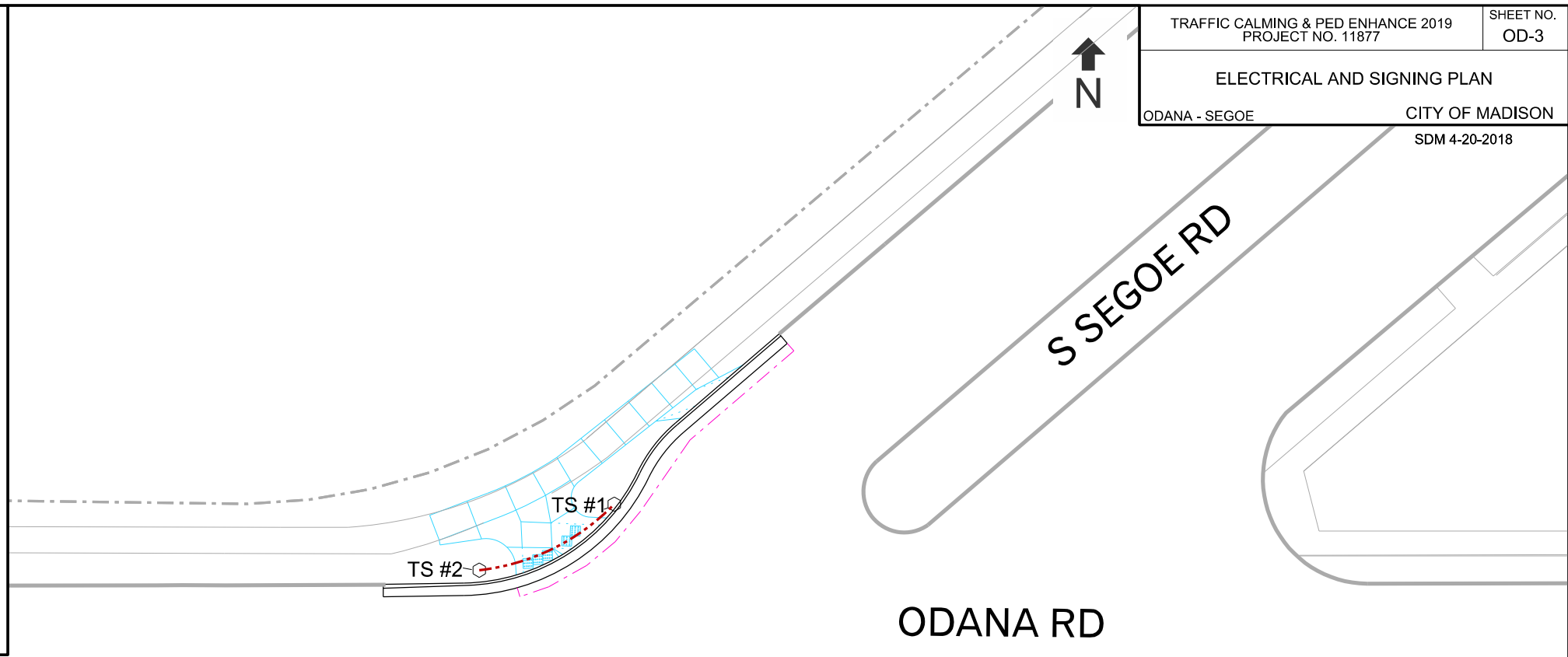

\$\$....designfile....\$\$

\$\$...plottingdate...\$\$



- NOTES:
1. TYPE 'E' CURB ON ALL ISLANDS/MEDIANS; SAWCUT AT EDGE OF GUTTER.
  2. INTERIOR OF ISLANDS TO BE STAMPED/COLORED CONCRETE, 7-INCH
  3. ALL ISLANDS/MEDIANS TO HAVE MOUNTABLE NOSES PER S.D.D. 3.13
  4. PROTECT PAVEMENT ON ODANA RD. ALL SAWCUTS TO BE AT EDGE OF PROPOSED CURB & GUTTER.
  5. REMOVE EXISTING PAVEMENT & CURB AS NECESSARY; EXISTING BASE COURSE TO REMAIN.

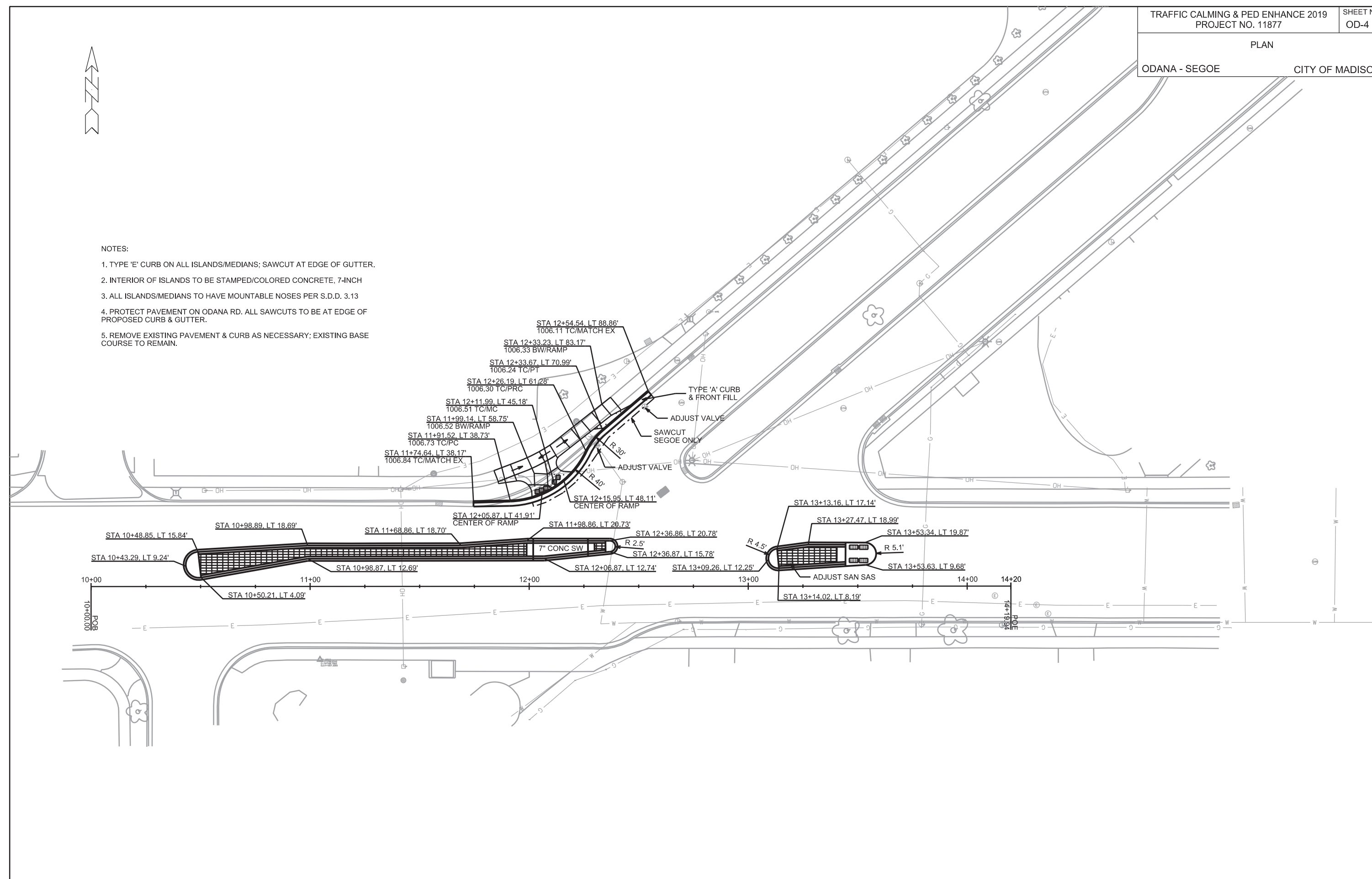

PLOT SCALE: \_\_\_\_\_

PLOT NAME: \_\_\_\_\_

REV. DATE: \_\_\_\_\_

ORIGINATOR: CITY OF MADISON, STREETS DIVISION



Grind off existing 6" crosswalk and install continental crosswalk

Lake Ct

229

225

279

W Olin Ave



307

CONTINENTAL CROSSWALK DETAIL

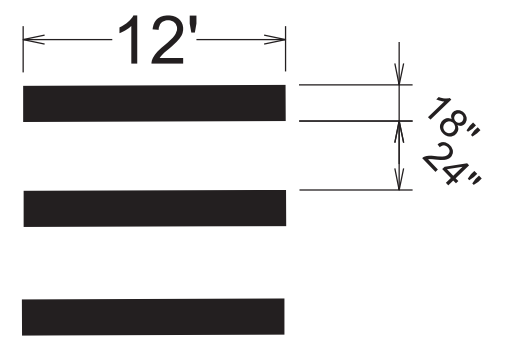

PLOT SCALE:

PLOT NAME:

REV. DATE:

ORIGINATOR: CITY OF MADISON, TRAFFIC ENG. DIV.



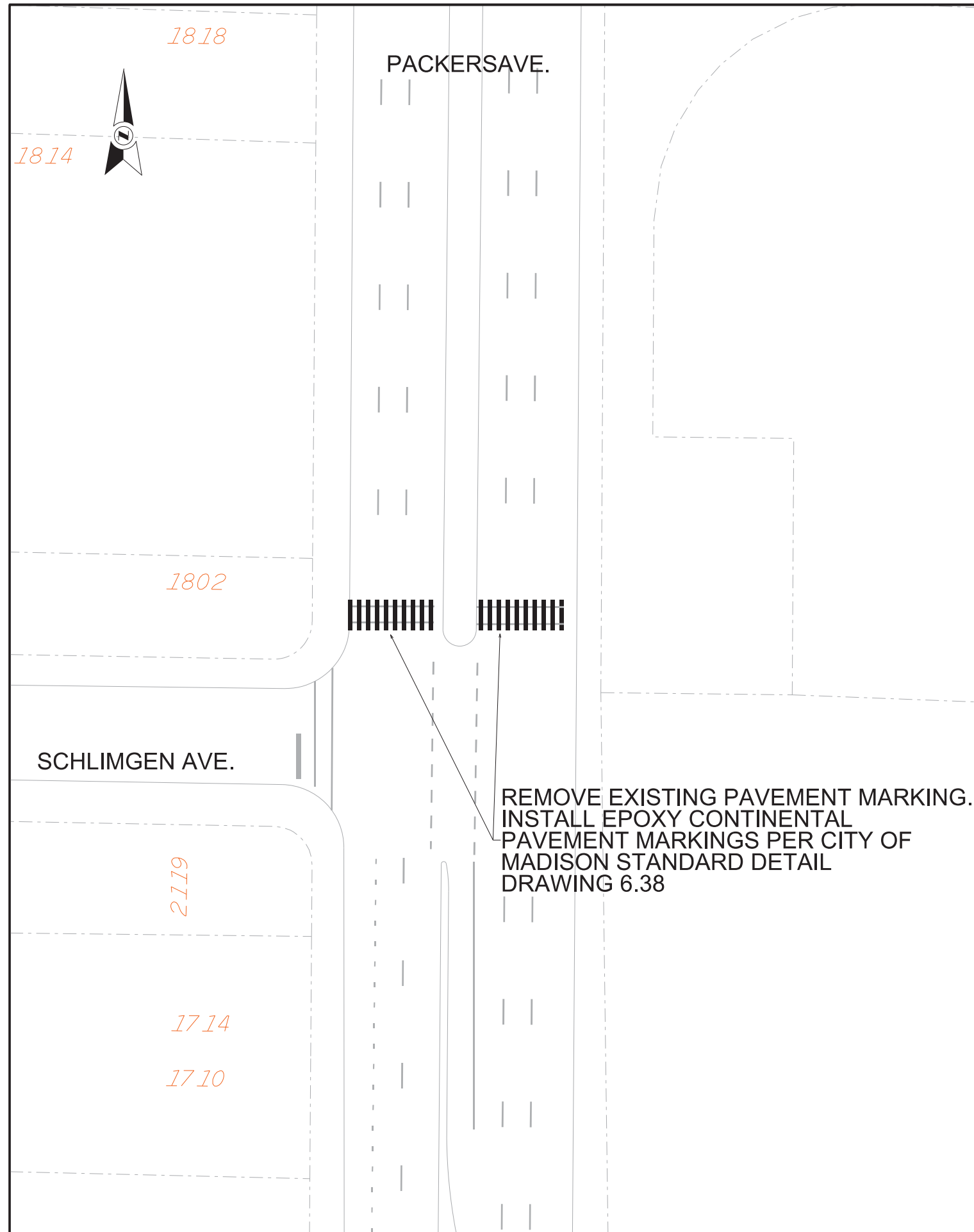

**GENERAL NOTES**

1. CONTRACTOR SHALL REMOVE EXISTING PAVEMENT MARKING FOR PEDESTRIAN CROSSING PACKERS AVENUE AT SCHLIMGEN AVENUE.
2. CONTRACTOR SHALL INSTALL EPOXY CONTINENTAL CROSSWALK PAVEMENT MARKING PER CITY OF MADISON STANDARD DETAIL DRAWING 6.38.
3. CONTACT: CITY OF MADISON TRAFFIC ENGINEERING, JERRY SCHIPPA, (608) 267-1969, JSCHIPPA@CITYOFMADISON.COM

*CONTRACTOR SHALL CONFORM TO THE 2013 "WORK ZONE SAFETY: GUIDELINES FOR CONSTRUCTION, MAINTENANCE, & UTILITY OPERATIONS" BOOKLET: PAGE 17 FOR WORK ON SHOULDER OR PARKING LANE; PAGE 20 FOR MAINTAINING TWO-WAY TRAFFIC WITH WORK IN TRAVEL LANE; PAGE 21 FOR FULL LANE CLOSURE ON LOW VOLUME ROADS; AND PAGE 54 WHEN CLOSING SIDEWALKS OR MULTI-USE PATHS.*

PLOT SCALE:  
PLOT NAME:  
REV. DATE:  
ORIGINATOR: CITY OF MADISON, TRAFFIC ENG. DIV.



SCALE: 1" = 30'

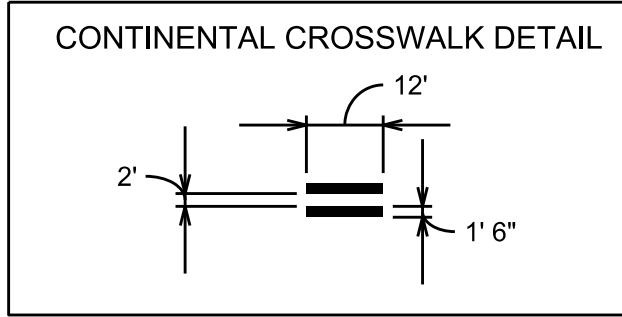

**GENERAL NOTES**

1. CONTRACTOR SHALL REMOVE EXISTING PAVEMENT MARKING ON THE WEST LEG CROSSING.

2. CONTRACTOR SHALL INSTALL EPOXY CONTINENTAL PAVEMENT MARKINGS AS SHOWN PER CITY OF MADISON STANDARD DETAIL DRAWING 6.38.

3. TE CREWS TO INSTALL RRFB AT NEW CONTINENTAL CROSSING.

CONTACT: CITY OF MADISON - TRAFFIC ENGINEERING, GRETCHEN AVILES PINEIRO (266-4899).

REMOVE EXISTING 6" CROSSWALK PAVEMENT MARKINGS  
REMOVE 12' OF EXISTING 6" BIKE LANE PAVEMENT MARKINGS AT THE NEW CONTINENTAL CROSSING

INSTALL NEW EPOXY CONTINENTAL PAVEMENT MARKINGS

FORWARD DR

SCHROEDER RD

HATHAWAY DR

PLOT SCALE:

PLOT NAME:

REV. DATE:

ORIGINATOR: CITY OF MADISON, TRAFFIC ENG. DIV.

### CONTINENTAL CROSSWALK DETAIL



Remove Existing 12" Crosswalks

Install Epoxy Continental Crosswalk

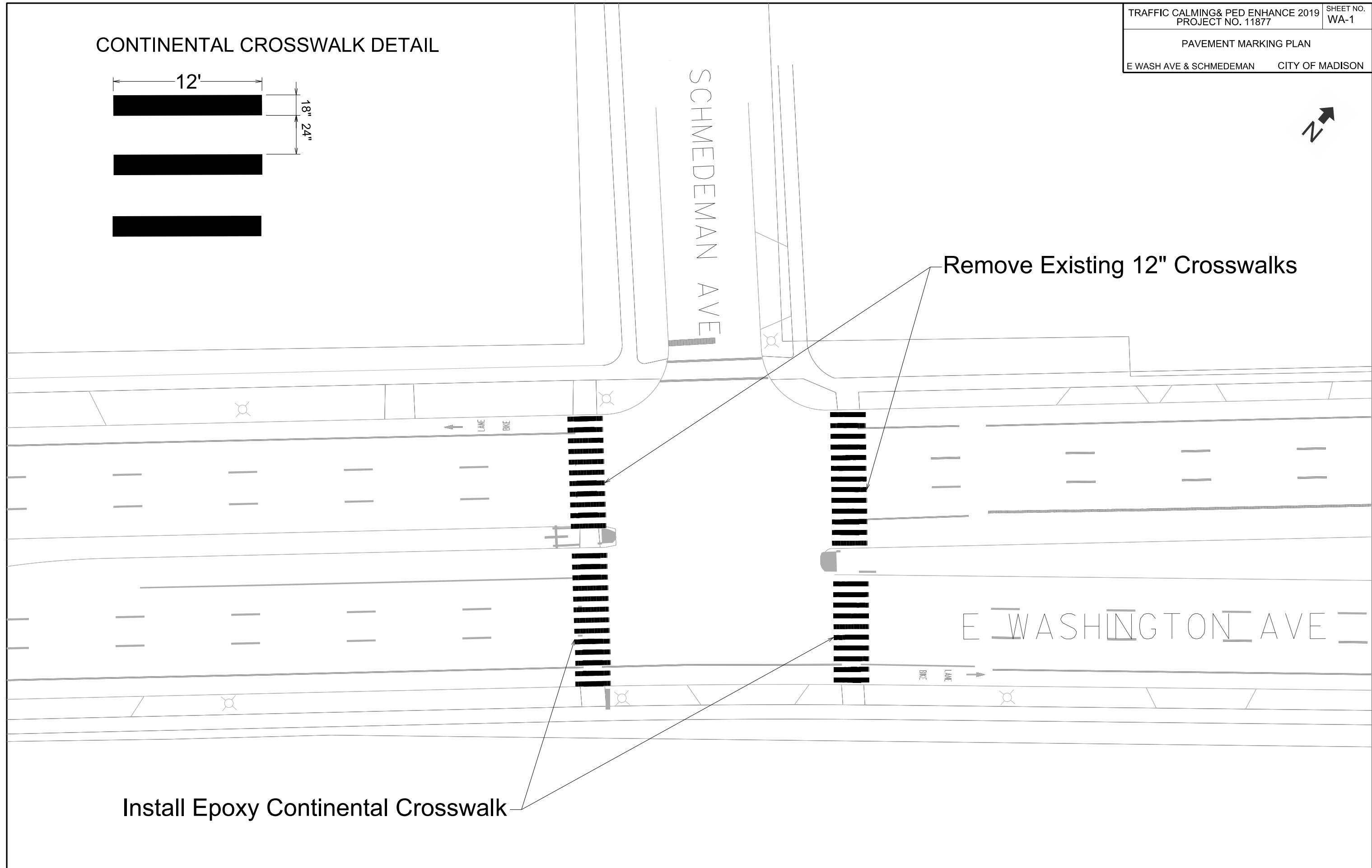

PLOT SCALE:  
PLOT NAME:  
REV. DATE:  
ORIGINATOR: CITY OF MADISON, TRAFFIC ENG. DIV.

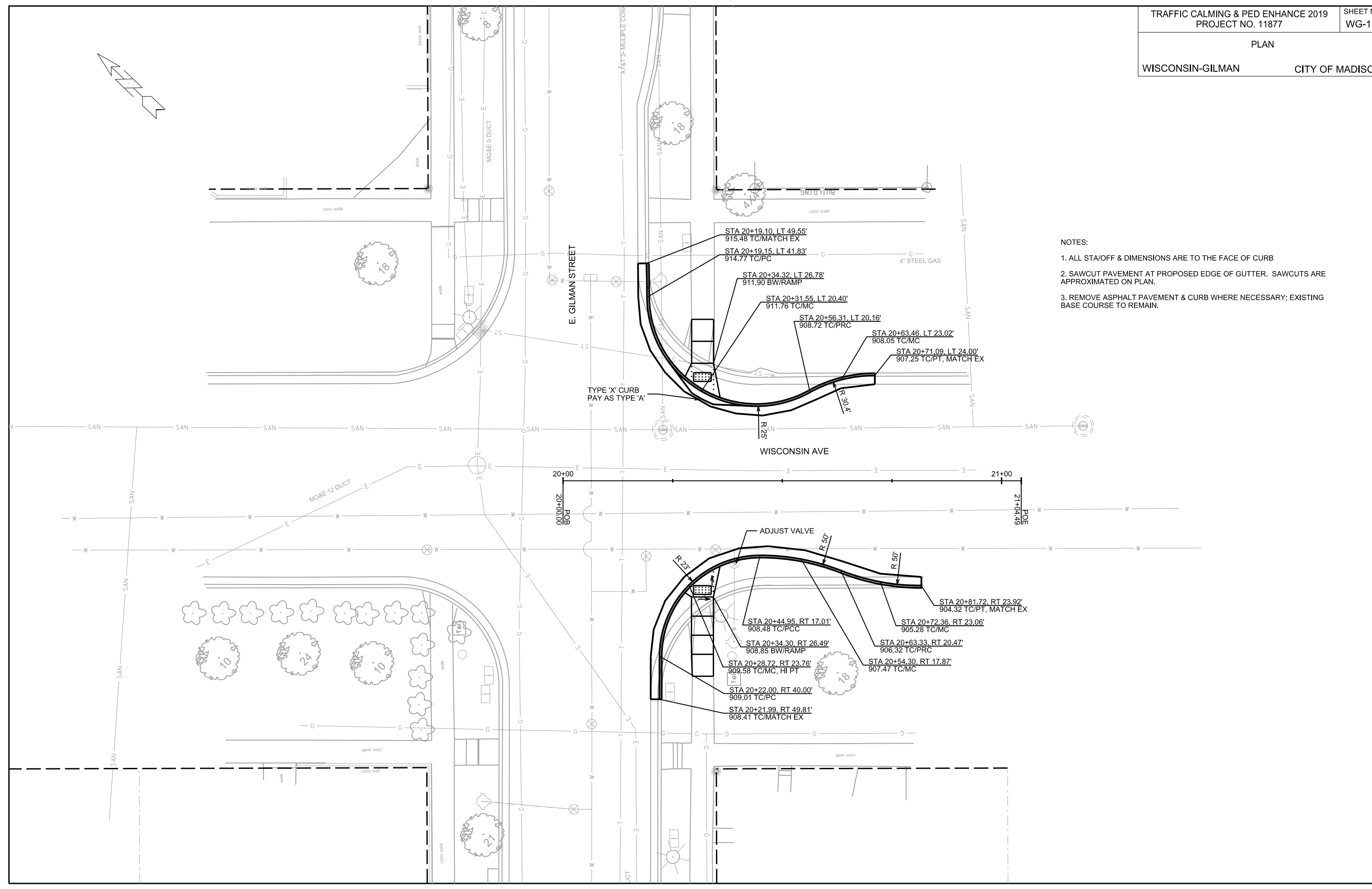
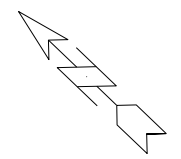

- NOTES:
1. ALL STA/OFF & DIMENSIONS ARE TO THE FACE OF CURB
  2. SAWCUT PAVEMENT AT PROPOSED EDGE OF GUTTER. SAWCUTS ARE APPROXIMATED ON PLAN.
  3. REMOVE ASPHALT PAVEMENT & CURB WHERE NECESSARY; EXISTING BASE COURSE TO REMAIN.

PLOT SCALE: \_\_\_\_\_

PLOT NAME: \_\_\_\_\_

REV. DATE: \_\_\_\_\_

ORIGINATOR: CITY OF MADISON, STREETS DIVISION



1398

1402

1406

Remove existing 12" crosswalks

WILLIAMSON ST

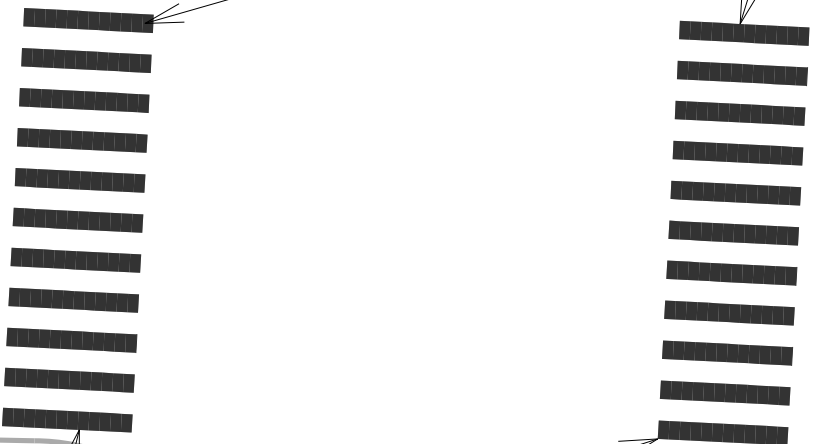

Install Epoxy Continental Crosswalks

S DICKINSON ST

CONTINENTAL CROSSWALK DETAIL

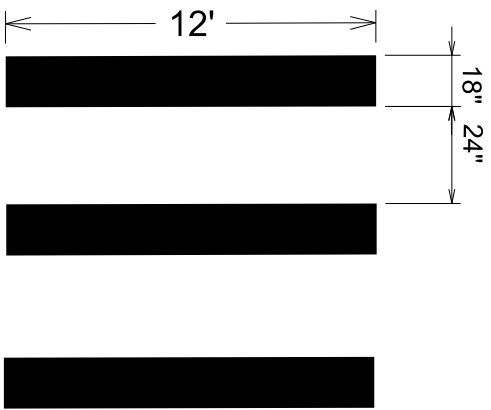

1353

1401

1403-1

1

PLOT SCALE:

PLOT NAME:

REV. DATE:

ORIGINATOR: CITY OF MADISON, TRAFFIC ENG. DIV.